



## 2-Jaw Scroll Chuck

(Soft jaw spec.) **JT**

- This chuck is the most suitable for gripping the deformed works such as valve, pipe joint.
- The dimensions of mounting part are the same as those of JN type.

### Dimension drawing

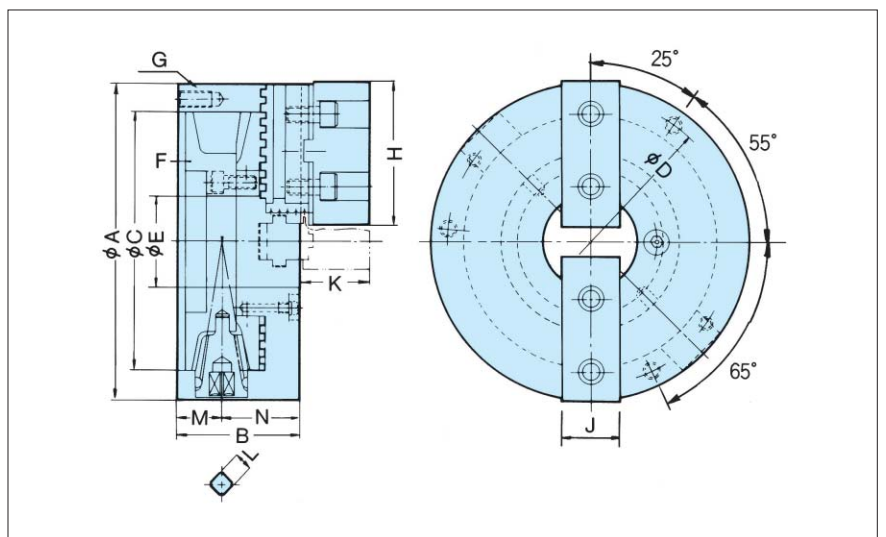

### Dimension table

Type	Size		C Size	C Tolerance	D Size	D Tolerance	E	F	G	H	J	K	L Size	L Tolerance	M	N	P
	A	B															
JT07	190	75	155	$+0.025_0$	172	$\pm 0.2$	55	5	3-M10	88	28	42	11	$+0.15_{+0.05}$	27.5	47.5	20
JT09	232	84	190	$+0.029_0$	210	$\pm 0.2$	70	6	3-M12	100	32	50	12	$+0.15_{+0.05}$	29.5	54.5	23

### Specifications

Type	Spec. Max. static gripping force KN(kgf)	Max. speed $\text{min}^{-1}(\text{r.p.m})$	Weight (with standard jaws) kg	GD <sup>2</sup> $\text{N}\cdot\text{m}^2(\text{kgf}\cdot\text{m}^2)$	Gripping range		Compatible hard jaw	Handle torque $\text{N}\cdot\text{m}(\text{kgf}\cdot\text{m})$
					Outer dia. $\phi$ mm	Inner dia. $\phi$ mm		
JT07	20.7(2110)	3500	12.6	2.55(0.26)	4~180	62~170	For JT07	73.5( 7.5)
JT09	24.7(2518)	2900	21.4	6.27(0.64)	5~220	70~210	For JT09	98 (10.0)



## 4-Jaw Scroll Chuck

(Integrated jaw) **JS**

- This chuck reduces the deformation when gripping works such as cylindrical objects, pipes that thickness is less.
- Grips the works of square shape.
- The dimensions of mounting part are the same as those of JN type.

### Dimension drawing

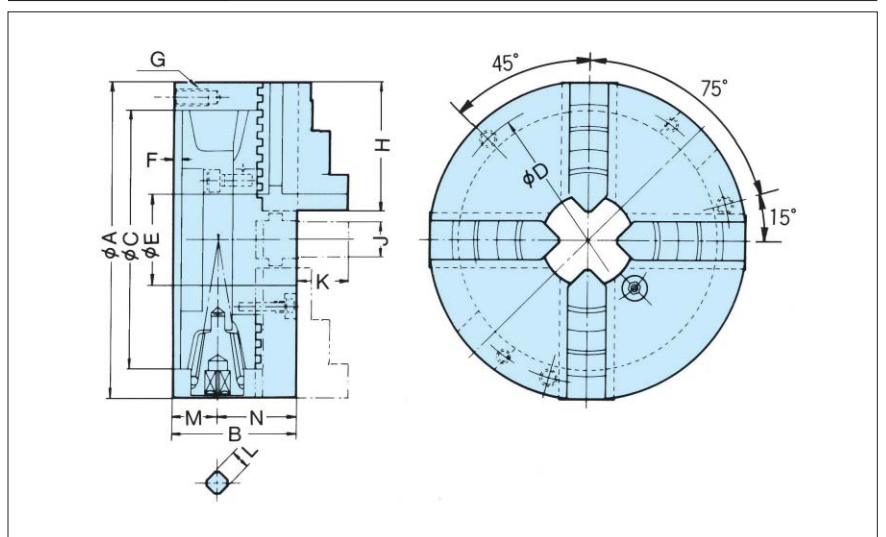

### Dimension table

Type	Size		C Size	C Tolerance	D Size	D Tolerance	E	F	G	H	J	K	L Size	L Tolerance	M	N	P
	A	B															
JS07	190	75	155	$+0.025_0$	172	$\pm 0.2$	55	5	3-M10	78	22.5	31	11	$+0.15_{+0.05}$	27.5	47.5	20
JS09	232	84	190	$+0.029_0$	210	$\pm 0.2$	70	6	3-M12	88	26.5	33	12	$+0.15_{+0.05}$	29.5	54.5	23

### Specifications

Type	Spec. Max. static gripping force KN(kgf)	Max. speed $\text{min}^{-1}(\text{r.p.m})$	Weight kg	GD <sup>2</sup> $\text{N}\cdot\text{m}^2(\text{kgf}\cdot\text{m}^2)$	Gripping range		Handle torque $\text{N}\cdot\text{m}(\text{kgf}\cdot\text{m})$
					Outer dia. $\phi$ mm	Inner dia. $\phi$ mm	
JS07	31(3161)	3500	12.5	2.45(0.25)	4~180	56~170	107.9(11.0)
JS09	37(3773)	2900	21.5	6.37(0.65)	5~220	62~210	147 (15.0)