

THE INFORMATION CONTAINED IN THIS DRAWING IS THE SOLE PROPERTY OF ABBOTT WORKHOLDING PRODUCTS. ANY REPRODUCTION IN PART OR WHOLE WITHOUT THE WRITTEN PERMISSION OF ABBOTT WORKHOLDING PRODUCTS IS PROHIBITED.

.275
.250
TYP.
Slot Depth

4"
MIN

1°
TYP.

Machined On Narrow
Side of Draft

1"
C'Bore Wall

(12 63/64")

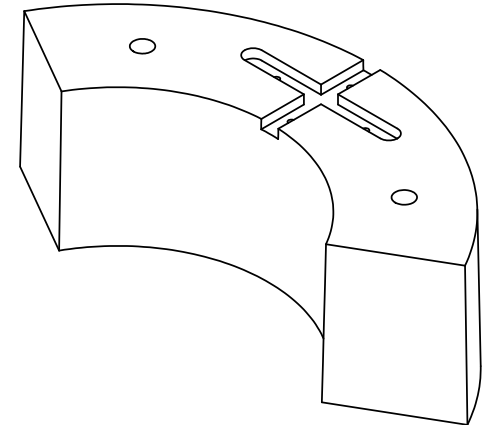

Ø 17/32" Thru Holes
Ø 15/16" C'Bore Holes
2X

1.403
TYP.

3.856
TYP.

(1 1/2")

.503
.501

1.312
TYP.

R1/4"
TYP.

(6")

Hole Pattern "K"

120°

R7 1/2"

R4 1/2"

4"

DETAIL A

.875
TYP.

10-32 x 1/2" ∇
4X

UNLESS OTHERWISE SPECIFIED
DIMENSIONS ARE IN INCHES
TOLERANCES ARE:
FRACTIONS DECIMALS ANGLES
±1/32 .XX±.015 ±5°
.XXX±.005
.XXXX±.0005

DRAWN TBJ	DATE 03/12/04
MATERIAL A319	WEIGHT(POUNDS) 15.2
STYLE O	DISPOSITION Released

Abbott Workholding Products

430 McCall Road
Manhattan, KS 66502
785-776-8555
785-587-0004 Fax
800-528-6459

www.abbottworkholding.com
engineering@abbottworkholding.com

CUSTOMER: Stock	SIZE A	Part Name 159SP4	REV. --
--------------------	-----------	---------------------	------------