

1.2 BSMG line

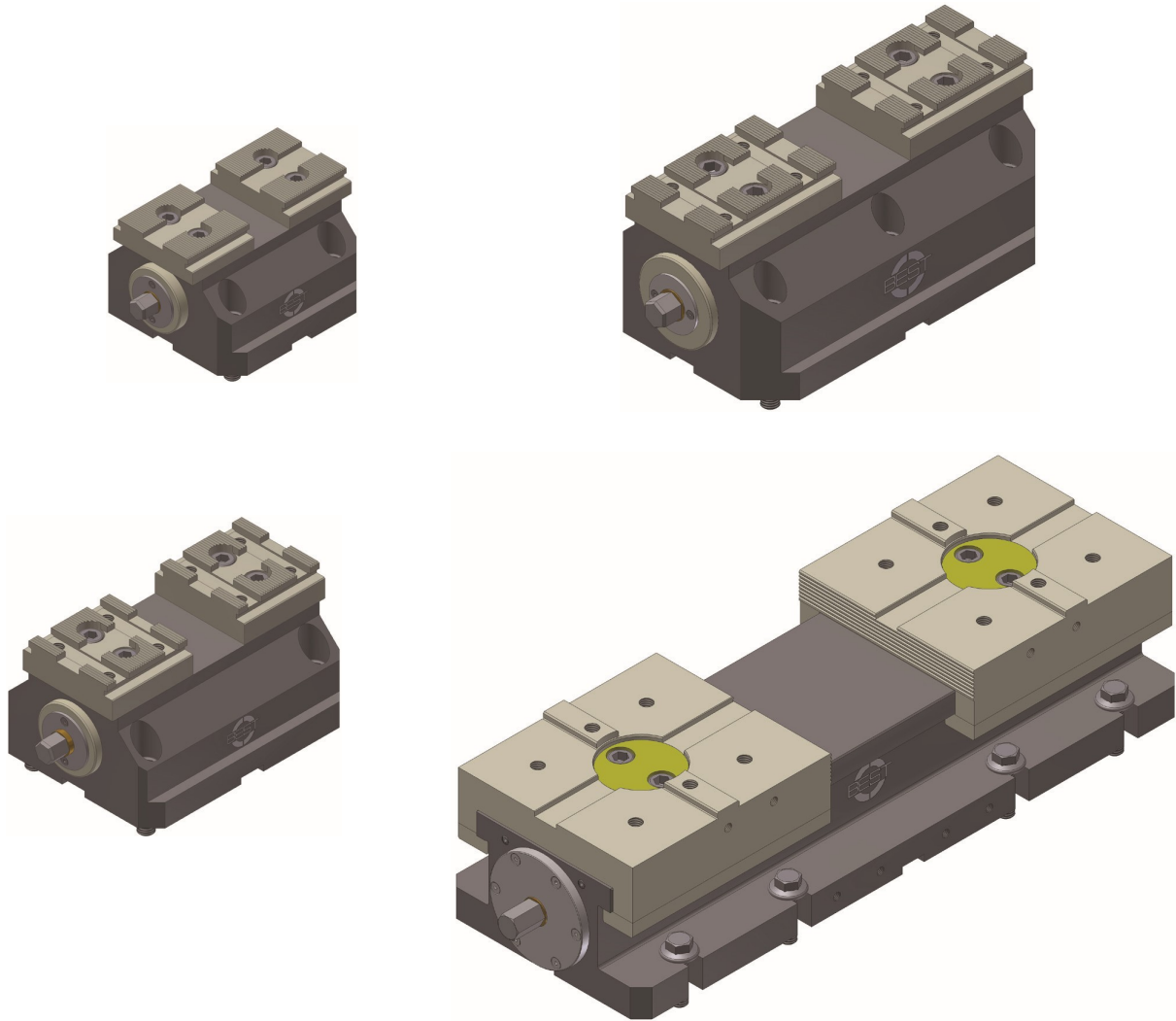

Advantages of BSMG centric vices:

- Highest-possible degree of process reliability in unmanned production operations as a result of the encapsulated design, which prevents soiling on the inside of the centric vice (with use of purge air)
- Extremely high rigidity as a result of solid design
- Extremely high clamping forces (up to 100 kN)
- Housing sizes from 140 mm to 500 mm
- Repetition accuracy of 0.005 mm (with ground-in jaws)
- Centring accuracy of +/- 0.01 mm (with ground in jaws)
- Jaw widths of up to 500 mm
- Low wear due to nitrogen-hardened surfaces
- Depending on requirements, the BSMG centric vice can be screwed conventionally to the machining table or used as a RPCG zero-point centric vice on the BEST Realpoint system

1.2.1 Encapsulated centric vice BSMG-140

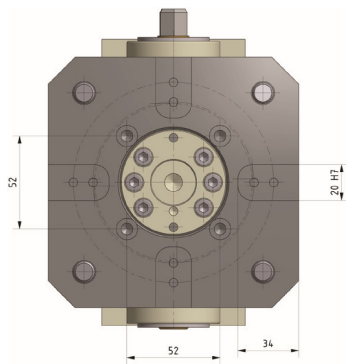

Technical data:

Order number:	220-0140-004
Designation:	BSMG-140
Installation length:	140 mm
Installation height:	97 mm
Weight:	10 kg
Clamping range:	0 – 130 mm
Stroke per jaw:	18 mm
Max. torque:	120 Nm
Max. clamping force:	40 kN
Jaw connection:	Quick-change

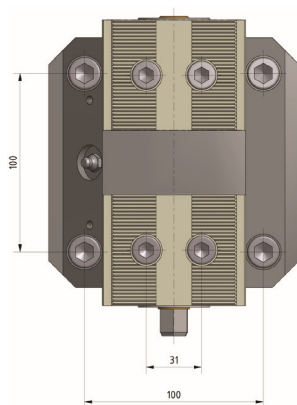
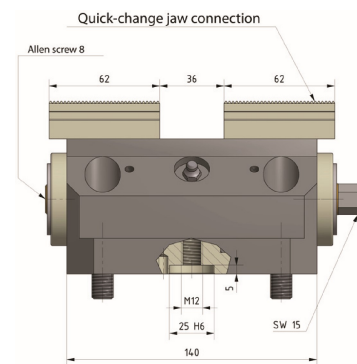
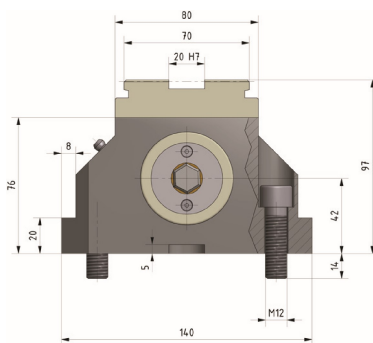

Clamping force – torque BSMG-140

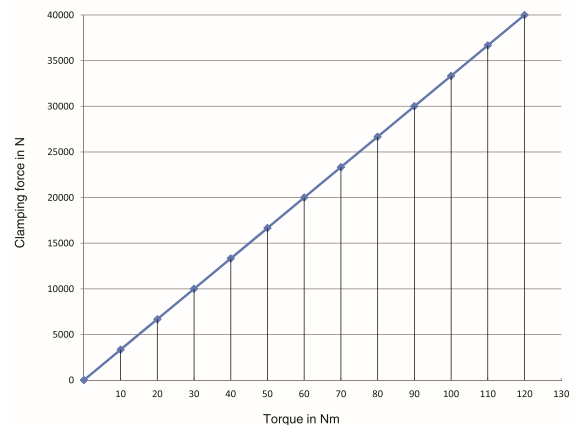

Installation options for the BSMG-140:

- The BSMG-140 centric vice can be attached to the machining table from above using screws or steel ties.
- The BSMG-140 can be quickly upgraded to an RPCG-140 zero-point centric vice (see page 41) simply by fitting a tightening bolt and two alignment bolts (see page 47).

You can find the corresponding jaws for the centric vice on pages 30 to 32.

1.2.2 Encapsulated centric vice BSMG-180

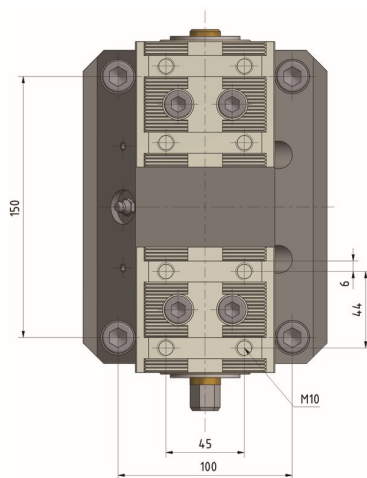
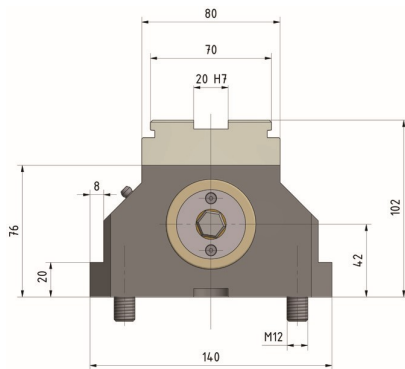
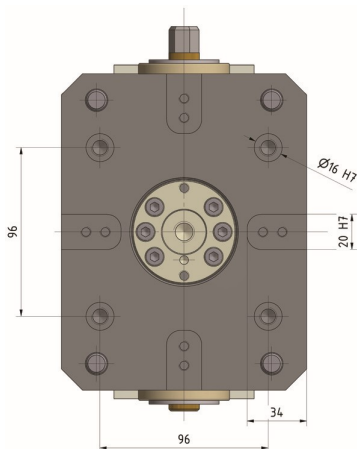

Technical data:

Order number:	220-0180-004
Designation:	BSMG-180
Installation length:	180 mm
Installation height:	102 mm
Weight:	13 kg
Clamping range:	0 – 170 mm
Stroke per jaw:	23 mm
Max. torque:	120 Nm
Max. clamping force:	40 kN
Jaw connection:	Quick-change and tongue and groove

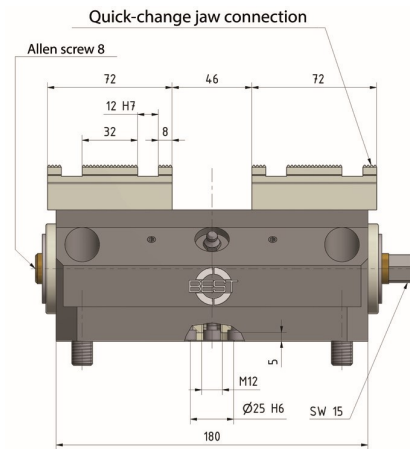

Clamping force – torque BSMG-180

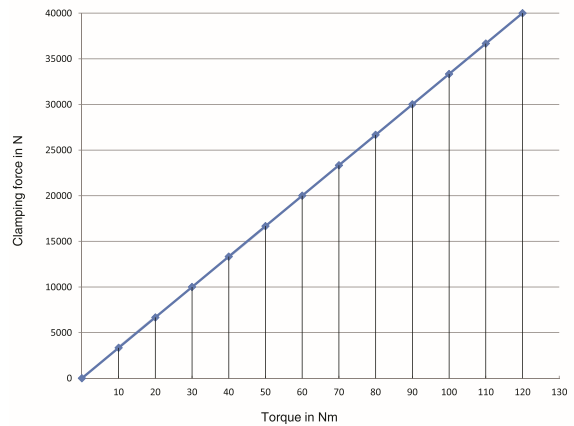

Installation options for the BSMG-180:

- The BSMG-180 centric vice can be attached to the machining table from above using screws or steel ties.
- The BSMG-180 can be quickly upgraded to an RPCG-180 zero-point centric vice (see page 41) simply by fitting a tightening bolt and two alignment bolts (see page 47).

You can find the corresponding jaws for the centric vice on pages 30 to 37.

1.2.3 Encapsulated centric vice BSMG-250

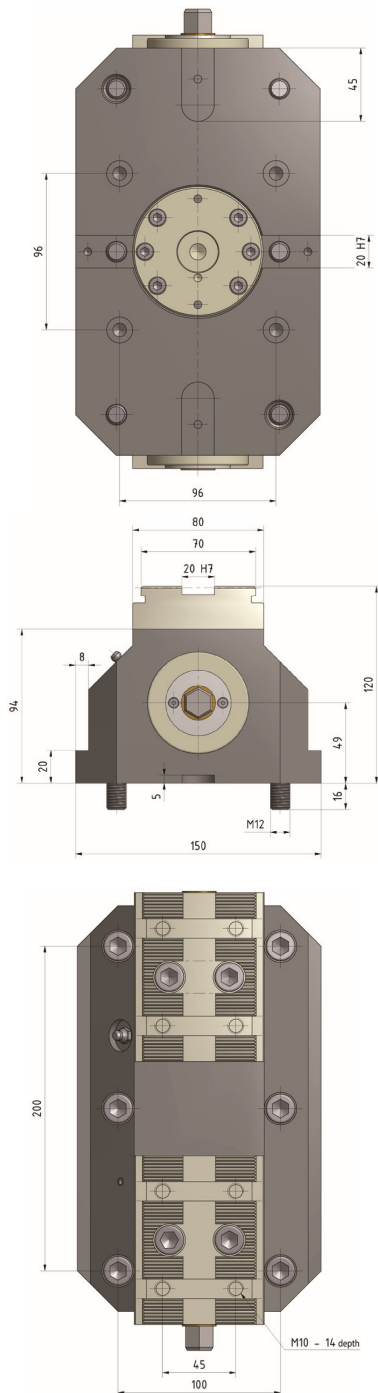

Technical data:

Order number:	220-0250-004
Designation:	BSMG-250
Installation length:	250 mm
Installation height:	120 mm
Weight:	23 kg
Clamping range:	0–240 mm
Stroke per jaw:	29 mm
Max. torque:	250 Nm
Max. clamping force:	90 kN
Jaw connection:	Quick-change and tongue and groove

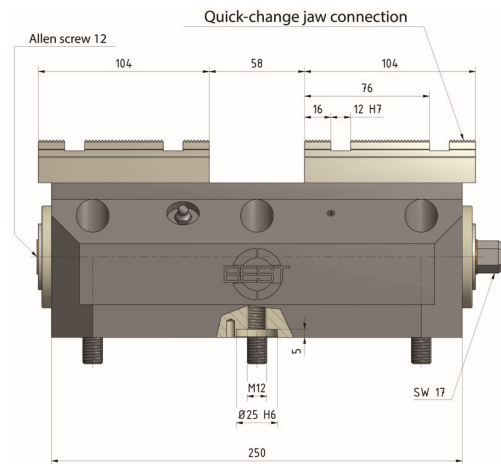

Clamping force – torque BSMG-250

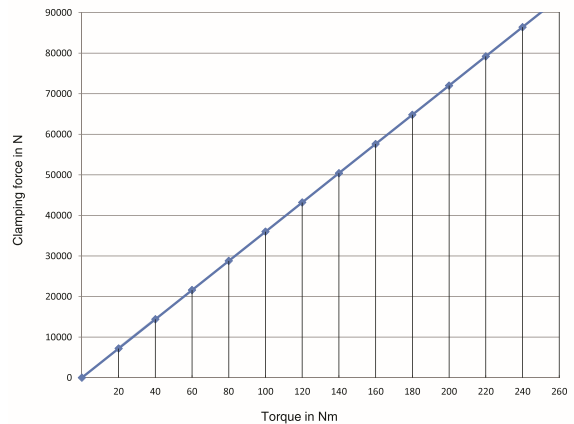

Installation options for the BSMG-250:

- The BSMG-250 centric vice can be attached to the machining table from above using screws or steel ties.
- The BSMG-250 can be quickly upgraded to an RPCG-250 zero-point centric vice (see page 41) simply by fitting a tightening bolt and two alignment bolts (see page 47).

You can find the corresponding jaws for the centric vice on pages 30 to 37.

1.2.4 Encapsulated centric vice BSMG-500

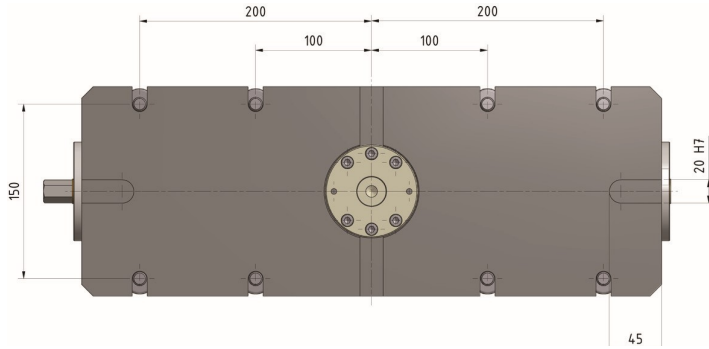

Technical data:

Order number:	220-0500-200
Designation:	BSMG-500
Installation length:	500 mm
Installation height:	119 mm
Weight:	70 kg
Clamping range:	0–500 mm
Stroke per jaw:	65 mm
Max. torque:	250 Nm
Max. clamping force:	93 kN
Jaw connection:	Tongue and groove

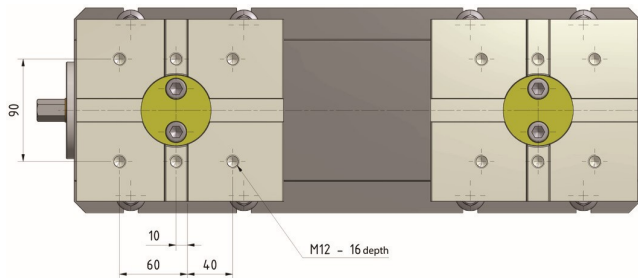
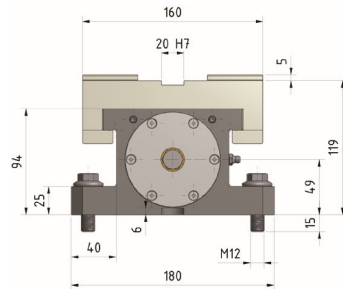
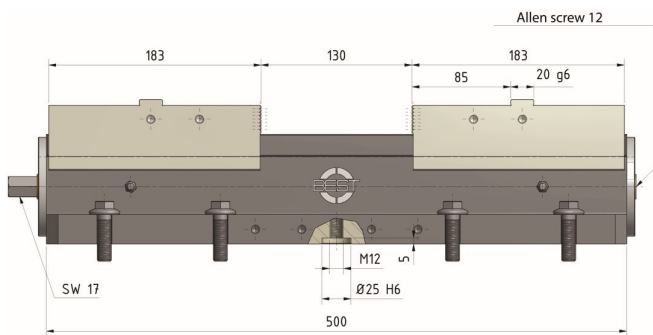

Clamping force – torque BSMG-500

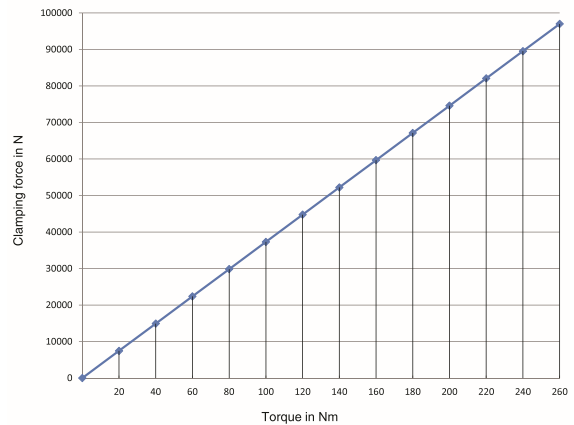

Installation options for the BSMG-500:

- The BSMG-500 centric vice can be attached to the machining table from above using screws or steel ties. You can find the corresponding jaws for the centric vice on pages 33 to 37.

1.2.5 Encapsulated centric vice special size BSMG-400

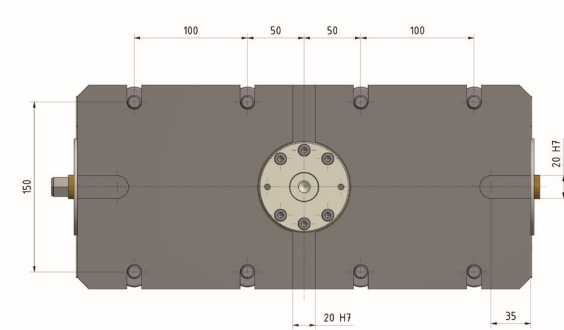

Technical data:

Order number:	220-0400-001
Designation:	BSMG-400
Installation length:	400 mm
Installation height:	119 mm
Weight:	48 kg
Clamping range:	0–400 mm
Stroke per jaw:	50 mm
Max. torque:	250 Nm
Max. clamping force:	93 kN
Jaw connection:	Tongue and groove

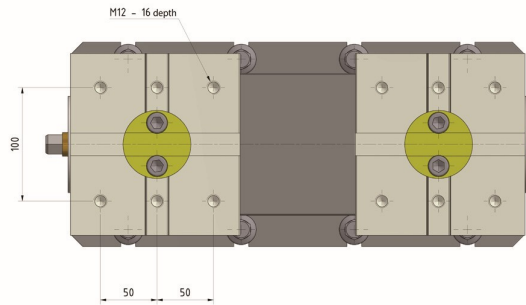
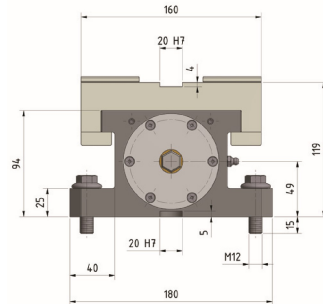
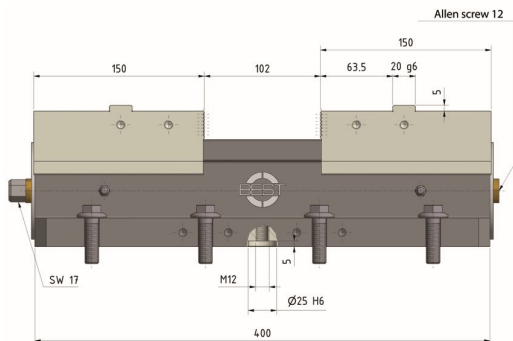

Clamping force – torque BSMG-400

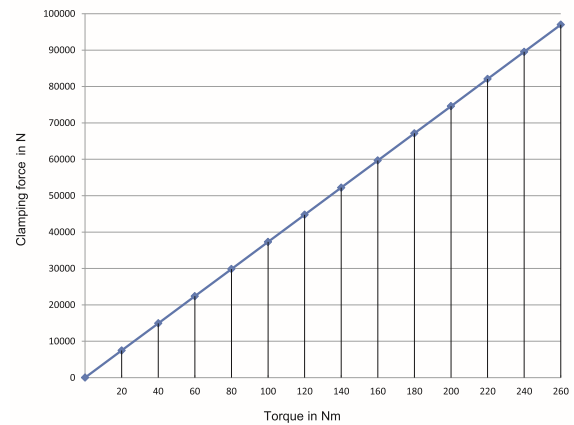

Installation options for the BSMG-400:

- The BSMG-400 centric vice can be attached to the machining table from above using screws or steel ties.