



CHUCK

Lever Style Power Chuck (Direct Mount) BL200A series

Chuck Adaptor is equipped to suit Spindle Nose Flange work securely gripped

* CE correspondence



Standard Chuck

Dimensional Drawings

Fig.2

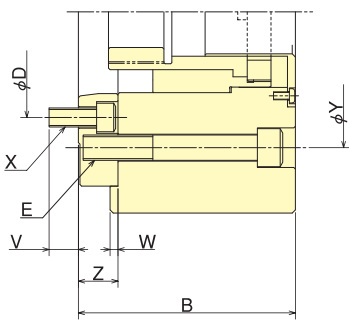
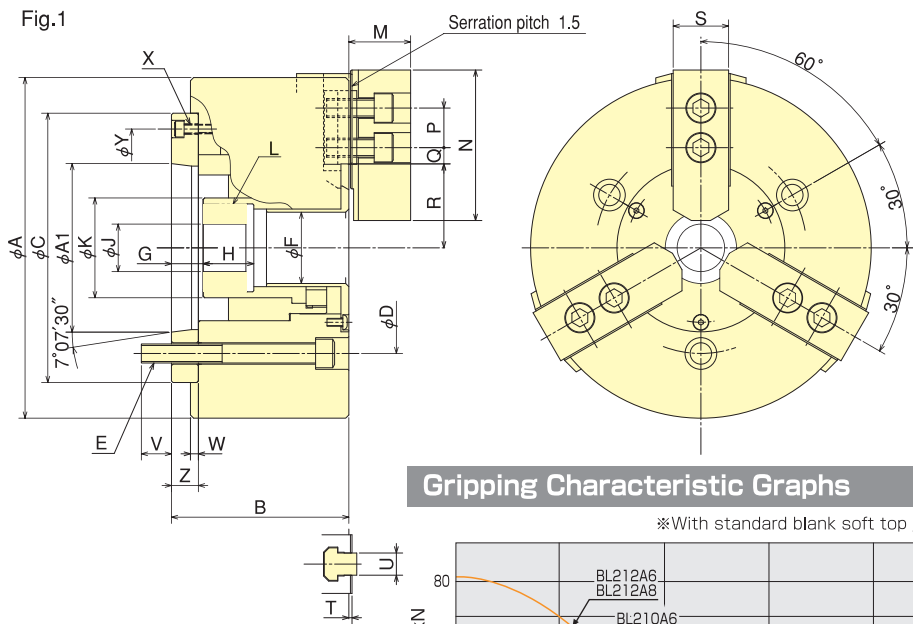
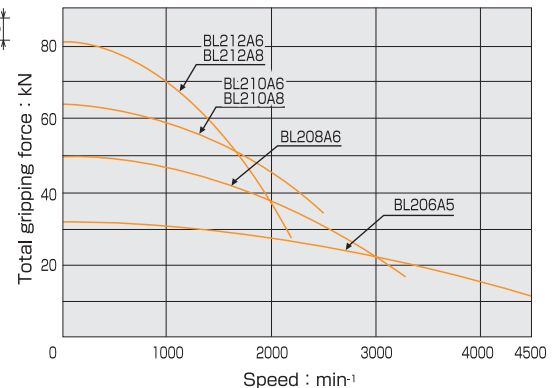

Fig.1



Gripping Characteristic Graphs

*With standard blank soft top jaw.



Dimensions

*BL210A6 and BL212A6 are based on Fig. 2. *Blank draw nut equipped.

| Dimensions Model | A | B | C | D | E | F | G max. | G min. | H | J | K | L max. | M | N | P | Q max. | Q min. | R max. | R min. | S | T | U | V | W | X | Y | Z | A1 |
|------------------|-----|-----|-----|-------|-------|----|--------|--------|----|----|----|---------|----|-----|----|--------|--------|--------|--------|----|---|----|------|---|-------|-------|----|---------|
| BL206A5 | 165 | 97 | 140 | 104.8 | 3-M10 | 28 | 25 | 10 | 24 | 20 | 45 | M38x1.5 | 29 | 66 | 20 | 16.75 | 9.25 | 39.25 | 29.25 | 26 | 2 | 12 | 16 | 5 | 3-M6 | 116 | 15 | 82.563 |
| BL208A6 | 215 | 112 | 170 | 133.4 | 3-M12 | 45 | 20 | 1 | 32 | 30 | 63 | M55x2 | 39 | 95 | 25 | 20.75 | 11.75 | 53 | 40.5 | 35 | 2 | 14 | 19 | 5 | 3-M6 | 150 | 17 | 106.375 |
| BL210A6 | 254 | 137 | 220 | 133.4 | 3-M16 | 53 | 19 | -3 | 40 | 45 | 73 | M65x2 | 43 | 110 | 30 | 26.25 | 11.25 | 62.5 | 47.5 | 40 | 2 | 16 | 18.5 | 5 | 6-M12 | 171.4 | 25 | 106.375 |
| BL210A8 | 254 | 130 | 220 | 171.4 | 3-M16 | 53 | 12 | -10 | 40 | 45 | 73 | M65x2 | 43 | 110 | 30 | 26.25 | 11.25 | 62.5 | 47.5 | 40 | 2 | 16 | 24 | 5 | 3-M8 | 190 | 18 | 139.719 |
| BL212A6 | 304 | 158 | 220 | 133.4 | 3-M16 | 63 | 33.2 | 8.2 | 38 | 50 | 83 | M75x2 | 52 | 111 | 30 | 38.25 | 12.75 | 74.5 | 57 | 50 | 3 | 21 | 18.5 | 5 | 6-M12 | 171.4 | 25 | 106.375 |
| BL212A8 | 304 | 151 | 220 | 171.4 | 3-M16 | 63 | 26.2 | 1.2 | 38 | 50 | 83 | M75x2 | 52 | 111 | 30 | 38.25 | 12.75 | 74.5 | 57 | 50 | 3 | 21 | 25 | 5 | 3-M8 | 190 | 18 | 139.719 |

Specifications

| Specifications Model | Thru-Hole mm | Gripping range mm Max. Min. | Jaw Stroke (diameter) mm | Plunger Stroke mm | Max. Draw Bar Pull Force kN (kgf) | Max. Gripping Force kN (kgf) | Max. Speed min⁻¹ | Net Weight with Soft top jaws kg | Moment of inertia kg·m² | Matching Cylinder | Max. pressure MPa(kgf/cm²) | Matching Hard top jaw | Matching Soft top jaw | Spindle nose size |
|----------------------|--------------|-----------------------------|--------------------------|-------------------|-----------------------------------|------------------------------|------------------|----------------------------------|-------------------------|-------------------|----------------------------|-----------------------|-----------------------|-------------------|
| BL206A5 | 28 | 165 28 | 20 | 15 | 27.9(2845) | 31.2(3182) | 4500 | 15.2 | 0.048 | S1246 | 3.40(34.7) | HB06B1 | SB06L1A | A2-5 |
| BL208A6 | 45 | 215 32 | 25 | 19 | 41.1(4191) | 49.0(4997) | 3300 | 26 | 0.208 | S1552 | 2.99(30.5) | HB08A1 | SB08B1 | A2-6 |
| BL210A6 | 53 | 254 42 | 30 | 22 | 53.8(5486) | 63(6424) | 3000 | 50.5 | 0.351 | S1875 | 3.20(32.6) | HB10A1 | SB10B1 | A2-6 |
| BL210A8 | 53 | 254 42 | 30 | 22 | 53.8(5486) | 63(6424) | 3000 | 48 | 0.325 | S1875 | 3.20(32.6) | HB10A1 | SB10B1 | A2-8 |
| BL212A6 | 63 | 304 43 | 35 | 25 | 69.3(7067) | 80.4(8199) | 2200 | 78 | 0.918 | S2091 | 3.22(32.8) | HB12N1 | SB12N1 | A2-6 |
| BL212A8 | 63 | 304 43 | 35 | 25 | 69.3(7067) | 80.4(8199) | 2200 | 81.2 | 0.943 | S2091 | 3.22(32.8) | HB12N1 | SB12N1 | A2-8 |