

BP20

M/C ANGLE PLATE

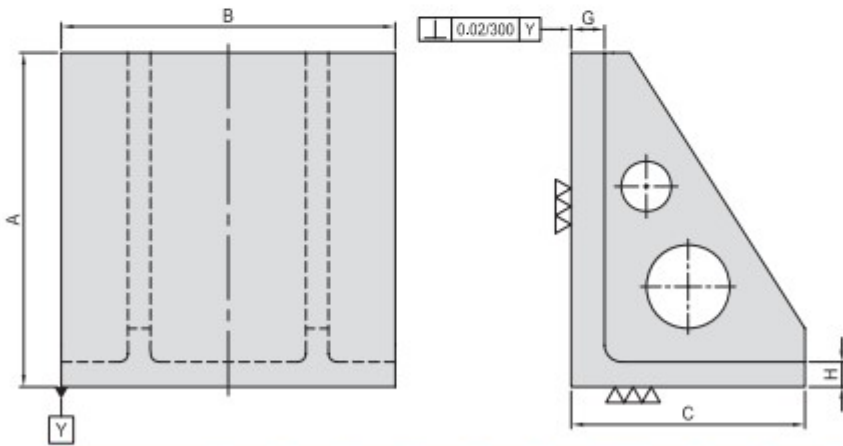

- Material / Finish:
Material: Cast Iron FC300(JIS) / GG30(DIN)
Heat treated (Normalized)
- Application: HMC / VMC
- Features: Ready to accept a hole pattern for your special jig.

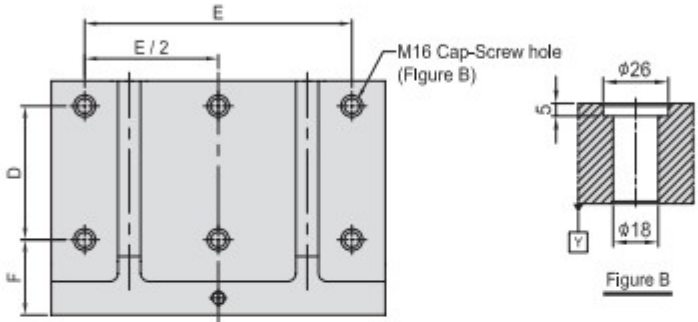

MODEL NO.	A	B	C	D	E	F	G	H	Mounting holes	kg
BP20-220300-0300	300	300	220	100	250	90	40	30	6	50
BP20-280400-0400	400	400	280	160	320					90
BP20-340500-0500	500	500	340	200	400	100	50	40	6	165
BP20-435630-0630	630	630	435	250	500					100
BP20-525800-0800	800	800	525	320	640	115	50	45	6	475

*Special Design Welcome !