

BP24

MC NARROW ANGLE PLATE



- Material / Finish:
Material: Cast Iron FC300(JIS) / GG30(DIN)
Heat treated (Normalized)
- Application: HMC / VMC.
- Features: Alignment bushing & thread insert at every hole location, easily adapts to standardized jig components.

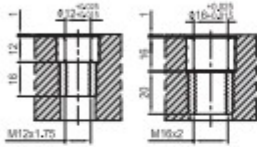

Figure G

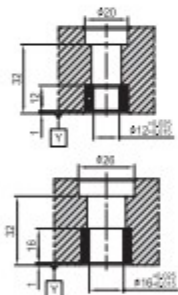
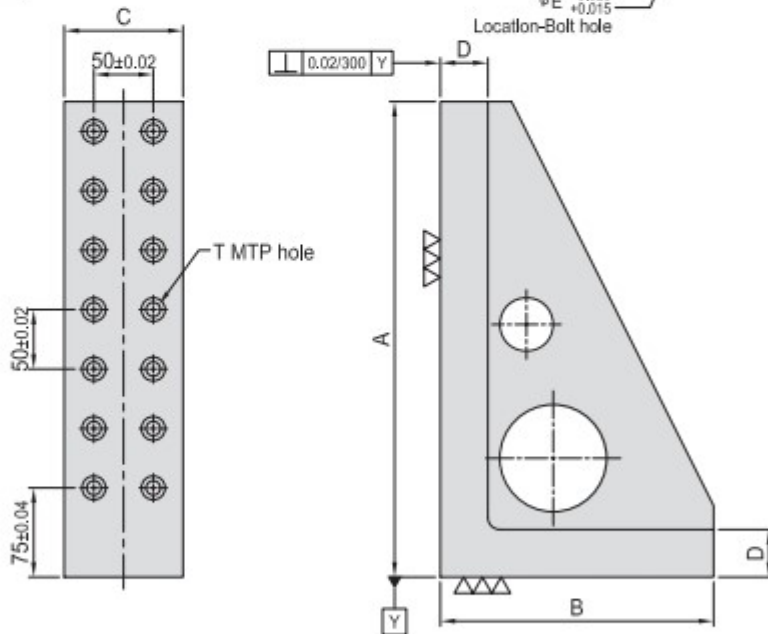

Figure E



MODEL NO.	A	B	C	D	E	F	T	MTP	Mounting holes	kg	
BP24-180100-0300-12	300	180						10	6	12	
BP24-230100-0400-12	400	230	100	40	12	55	$\phi 12$	M12	14	8	19
BP24-280100-0500-12	500	280							18	10	23
BP24-180100-0300-16	300	180						10	6	13	
BP24-230100-0400-16	400	230	100	40	16	55	$\phi 16$	M16	14	8	20
BP24-280100-0500-16	500	280						18	10	24	

*Special Design Welcome !