

**APPLICATION EXAMPLE**

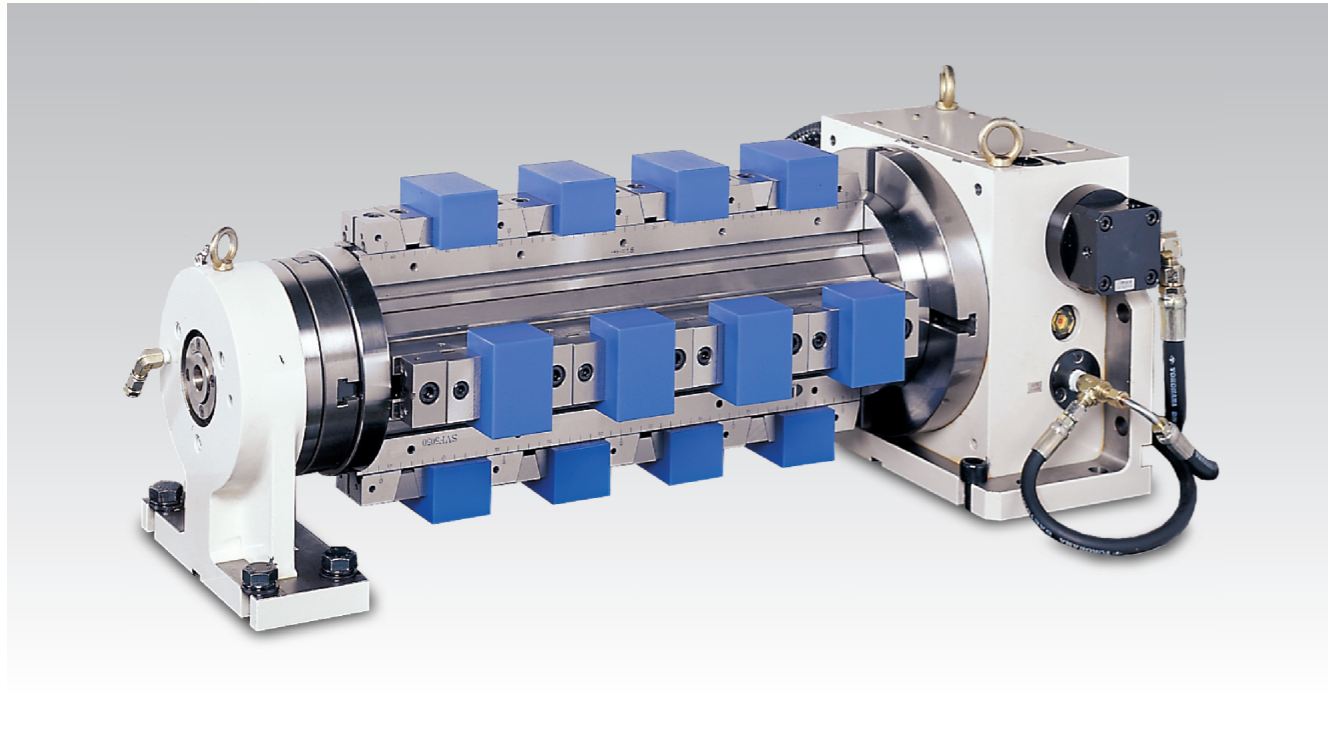

**ASSEMBLED**

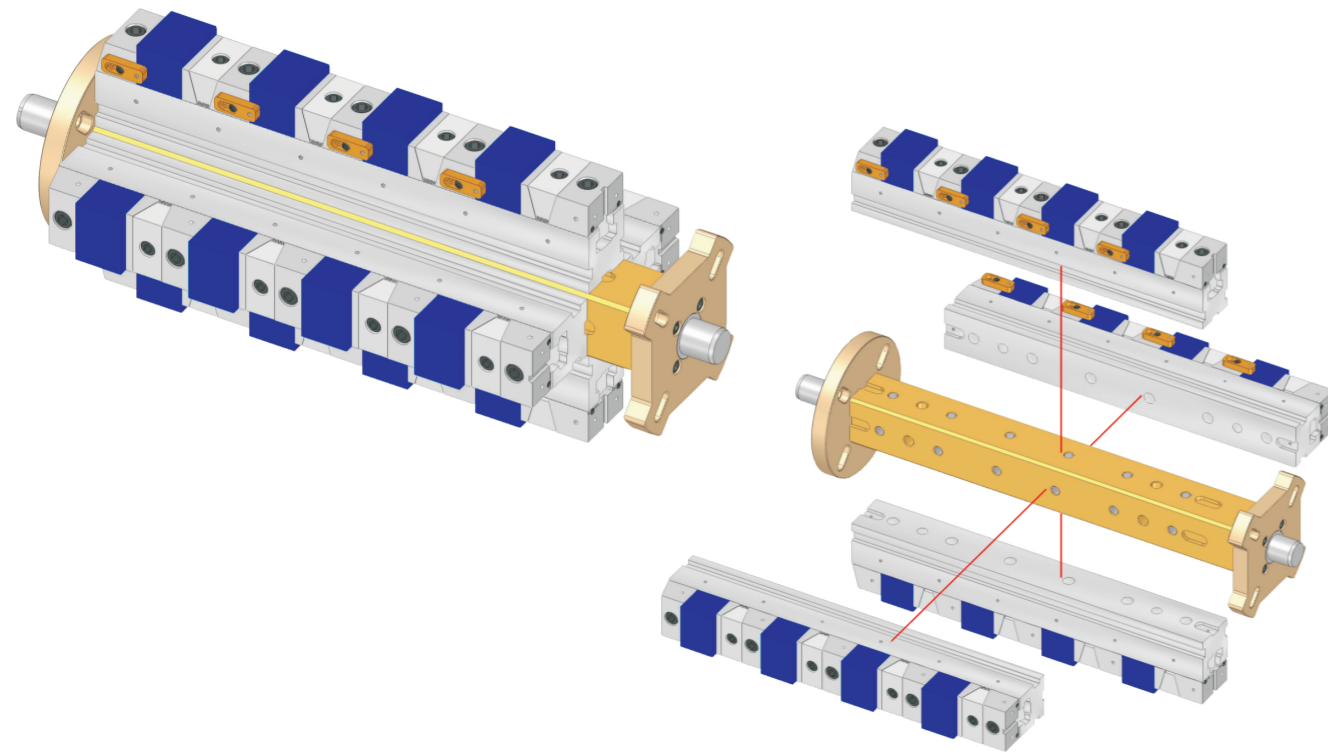

**AXLE**

• Material: S45C

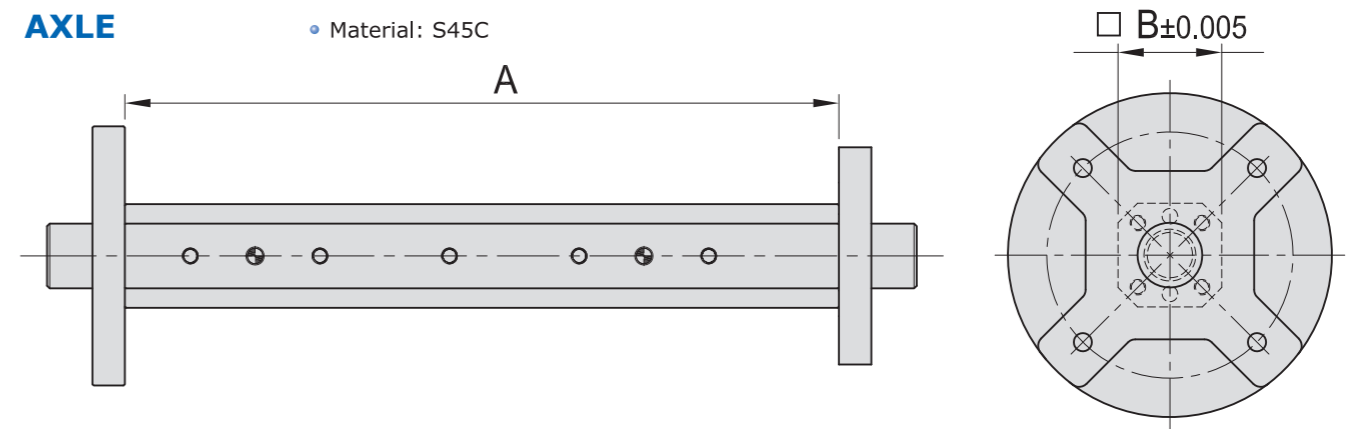

Model	A	B	kg	Model	A	B	kg
SVFX-5030-080	350	80	48.2	SVFX-7240-100	450	80	53.7
SVFX-5030-100				SVFX-7250-100	550	80	58.2
SVFX-5040-080	450	80	52.2	SVFX-7260-100	650	80	62.2
SVFX-5040-100				SVFX-7270-100	750	80	66.2
SVFX-5050-080	550	80	56.2	SVFX-10040-100	450	102	70.0
SVFX-5050-100				SVFX-10050-100	550	102	75.5
SVFX-5060-080	650	80	60.2	SVFX-10060-100	650	102	83.5
SVFX-5060-100				SVFX-10070-100	750	102	92.5
SVFX-5070-080	750	80	64.2				
SVFX-5070-100							

\*Please offer the brand and model no. of the indexing table and the tail stock that you use when you place an order.

**BASE PLATE**

• Material: S45C

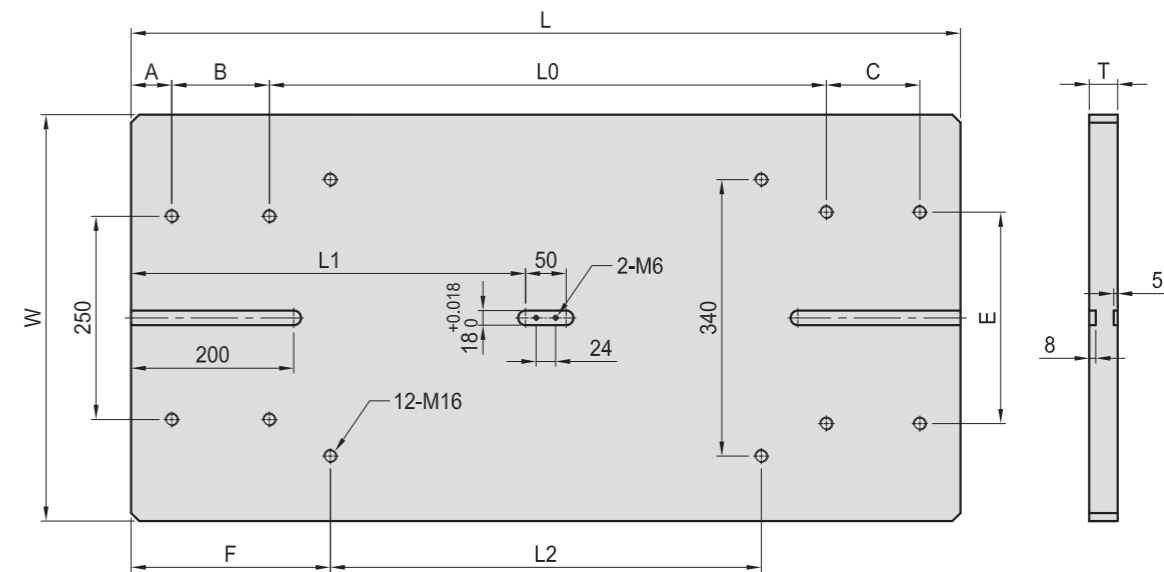

Model	L	L0	L1	L2	W	T	A	B	C	E	F
SVFX-5030BP	700	425	325	260							
SVFX-5040BP	800	525	375	360							
SVFX-5050BP	900	625	425	460	400	30	80	80	72	200	220
SVFX-5060BP	1000	725	475	560							
SVFX-5070BP	1100	825	525	660							
SVFX-7240BP	920	520	435	430							
SVFX-7250BP	1020	620	485	530							
SVFX-7260BP	1120	720	535	630	500	35	45	185	135	300	280
SVFX-7270BP	1220	820	585	730							

\*Special design welcome!

(Optional accessory available for being ordered separately)

BP

BPA

BC

CP

SU

PT

SVF

ALV

OK-  
VISE

OTHER

Column  
for  
Technical  
Data