

Strong & Compact NC Rotary Table

MK200

Specifications

Model	Table diameter mm	Registered diameter of table mm	Spindle through hole diameter mm	Centre height mm	Clamping method	Clamping torque N·m	Motor axis reduced inertia kg·m ²	Servo motor for FANUC spec.	Gear ratio
MK200R	φ 135	φ 65H7	φ 70	140	Pneumatic	570	0.00010	α iF4/5000	1/90
Max. spindle speed (Motor:3000min ⁻¹) min ⁻¹	Allowable work inertia kg·m ²	Indexing accuracy sec	Repeatability sec	Mass of product	Allowable load		Allowable cutting torque N·m	Built-in rotary joint (Option)	
33.3	1	20	4	58	Horizontal kg	Vertical kg	270	Hydraulic/Pneumatic 6 ports + 1port*	

※ 1 port is φ 12.5 multi purpose hole.

Dimensions

◆ Table Height
※ Motor case depth

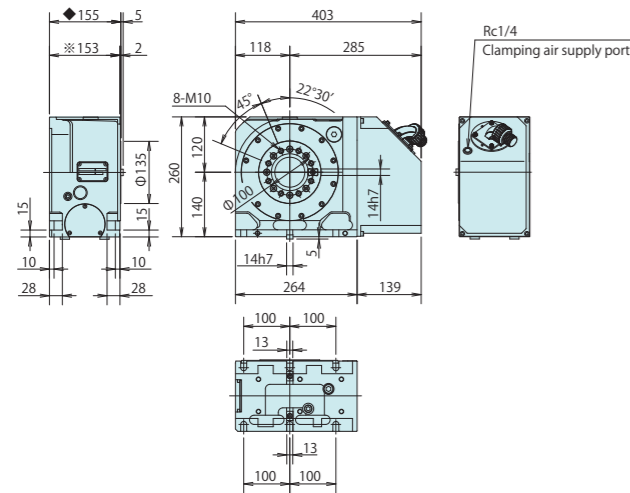

M signal spec.

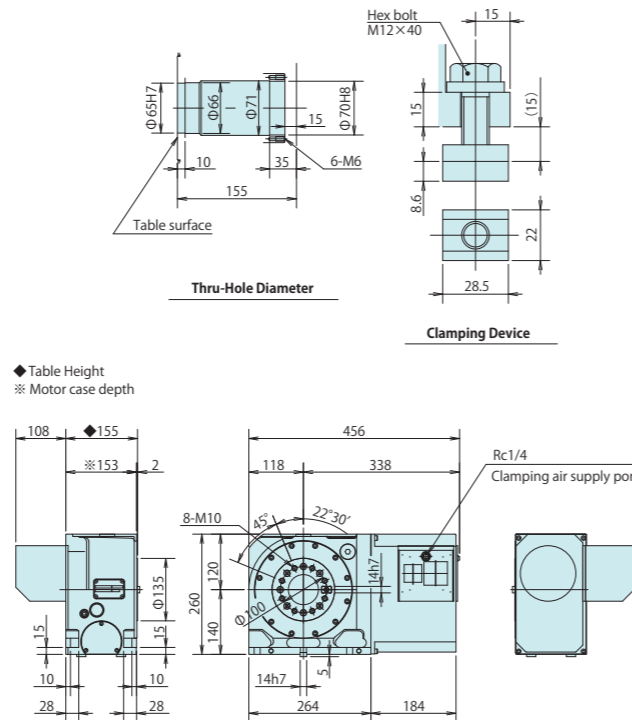

4th axis spec.

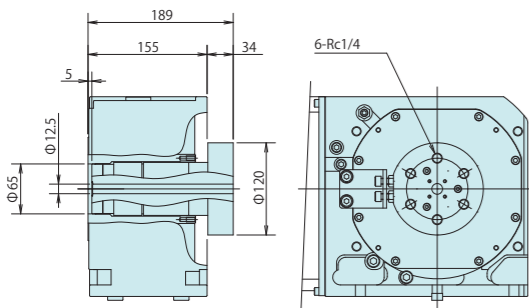

Built-in 6-port rotary joint

External dimensions of 4-port and 5-port rotary joints are the same as this.

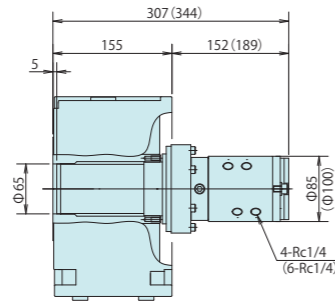

High-pressure 4-port rotary joint

Dimensions in () are for 6-port rotary joint.

Performance improved

Improved mounting

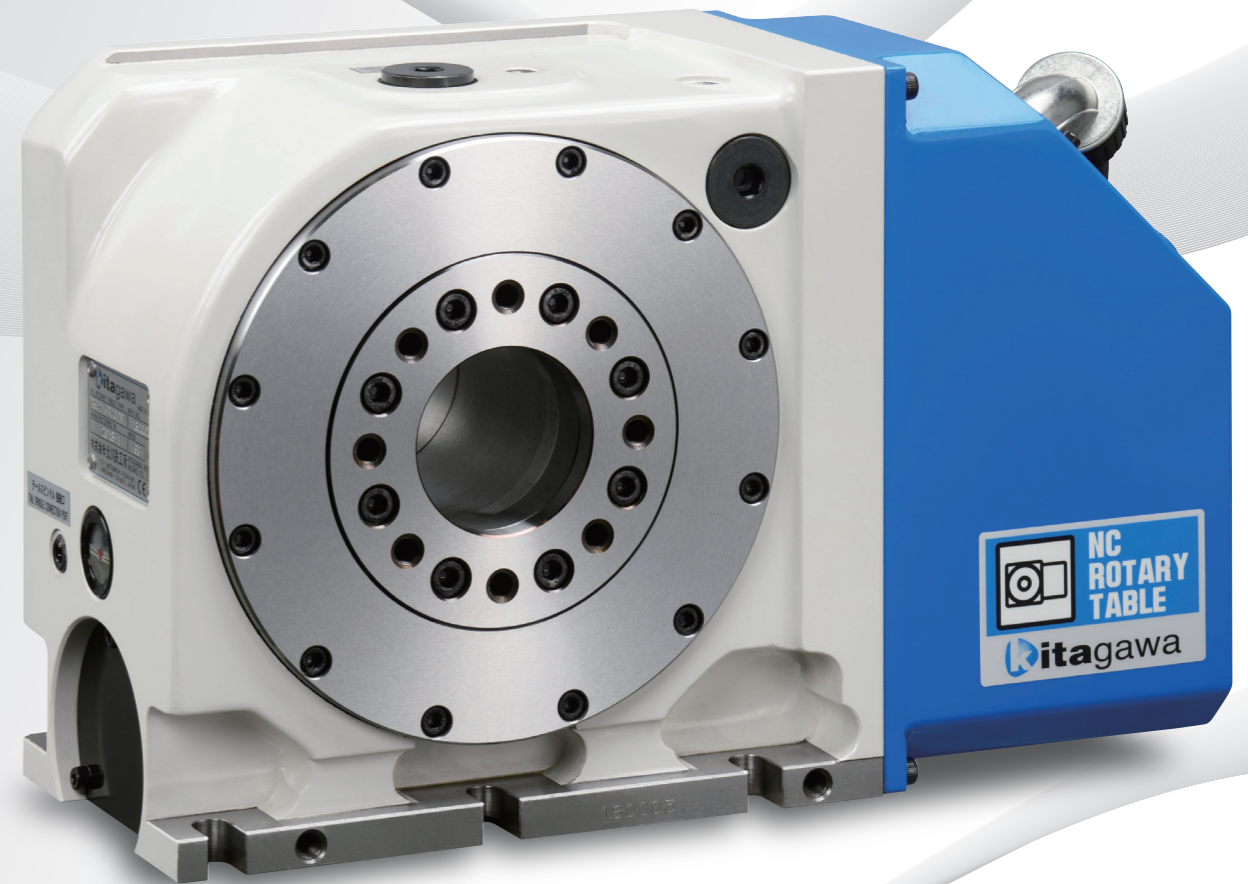

Wide selection of rotary joints

The Kitagawa's latest compact NC rotary table MK series has arrived. High-performance and easy-to use model.

Performance improved

Powerful clamping torque

Large capacity provides the highest specifications in its class

Clamping torque: 570Nm
(163% compared to our products in case of MK200)

Jig space and clamping torque are boosted by the design of the MK200 and our thin tail spindle.

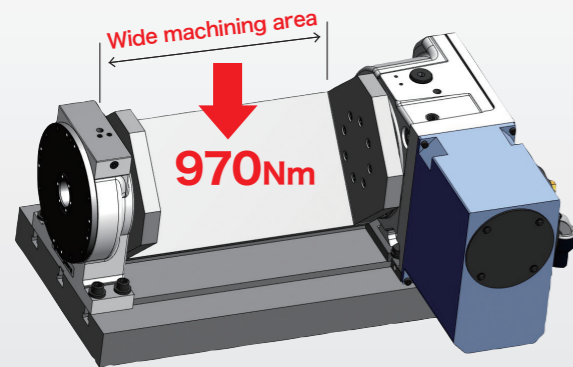

NC rotary table MK200 + Tail spindle TSRC140
= Total clamping torque

570Nm + 400Nm = 970Nm

High cutting torque

Large worm wheel design allows powerful lead cutting.

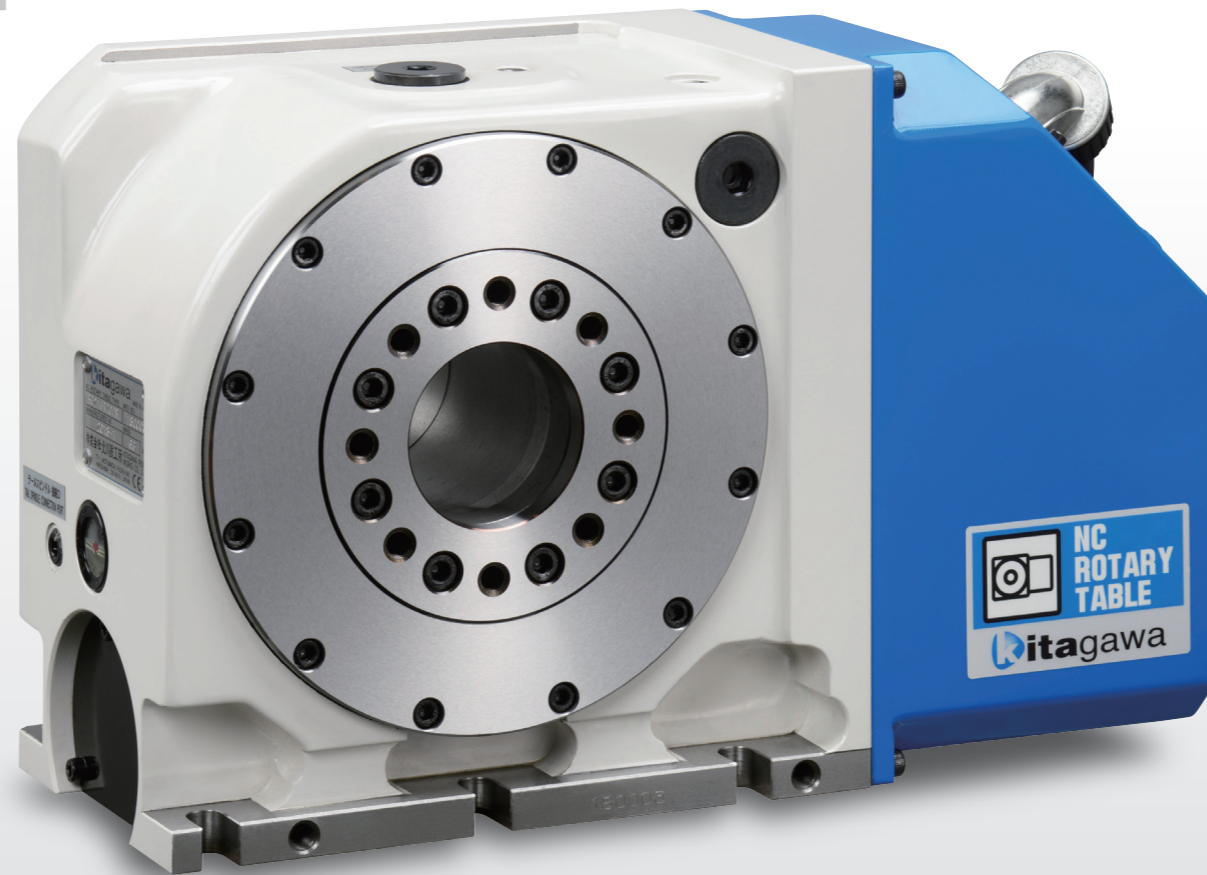
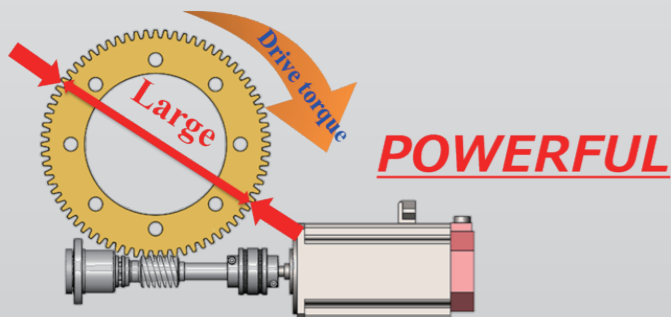

Improved mounting

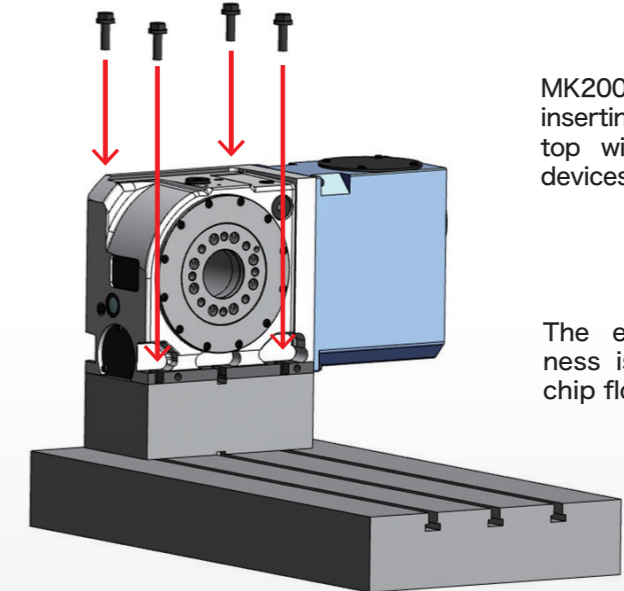

MK200 is installed by inserting bolts from the top without clamping devices.



The effective thickness is reduced and chip flow is improved.

MK series rotary table

The locator on riser block helps retain locating accuracy and assists with maintenance.

Locator

Riser block

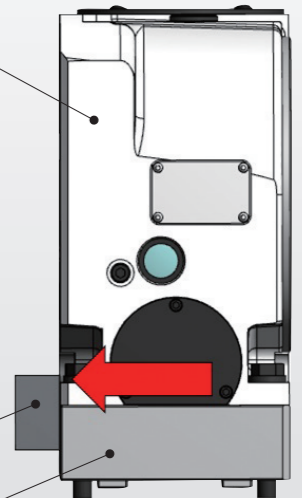

Wide selection of rotary joints

Compact built-in rotary joints can be selected from 4-, 5- and (6+1)-port types. The centre port of (6+1)-port type has a $\phi 12.5$ mm multi-purpose hole for high-pressure coolant, work seating detection sensor, etc.

25MPa high-pressure rotary joints (4-port or 6-port) are also available for miniaturization of fixtures and fast actuation.

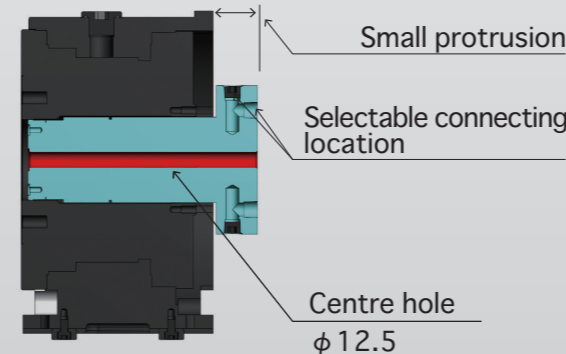

Built-in 6+1 ports

Built-in rotary joint (7MPa)

High pressure rotary joint (25MPa)

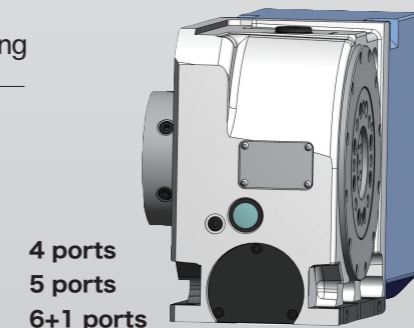

4 ports
5 ports
6+1 ports

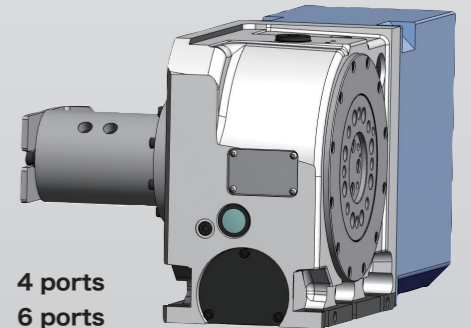

4 ports
6 ports