



**CHUCK**

# Closed Centre Power Chuck (Long Stroke) NL series

## Extra Long Jaw Stroke Flange work securely gripped

\*CE correspondence

### Dimensional Drawings

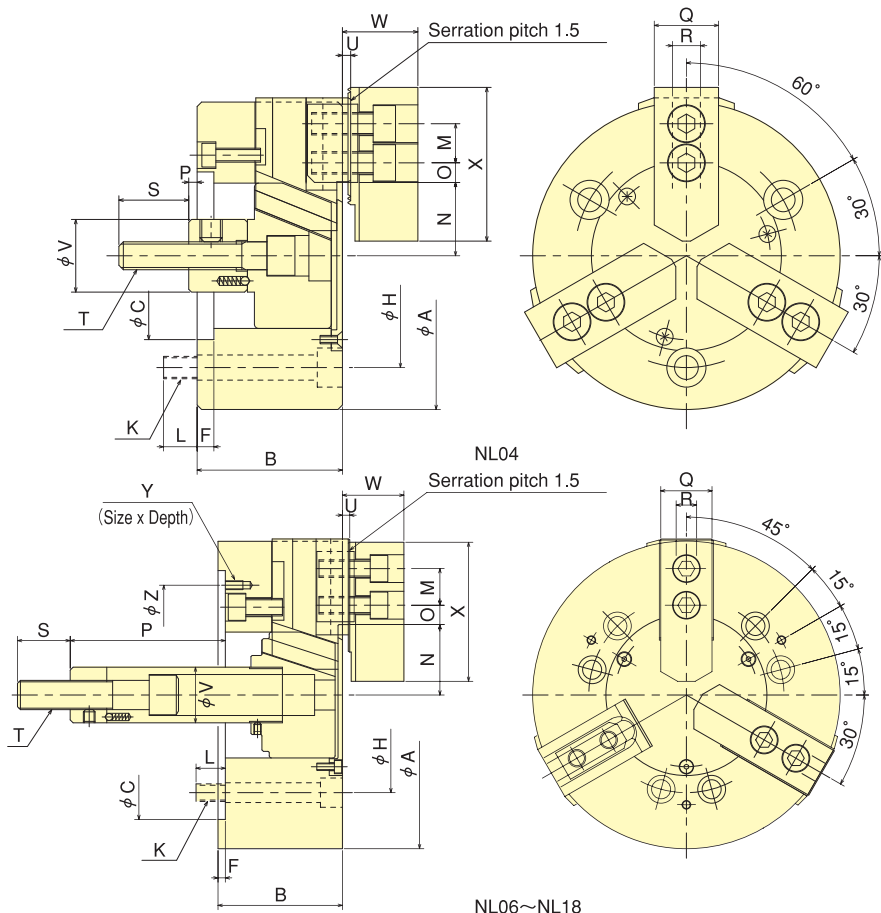

Standard Chuck

### Gripping Characteristic Graphs

\*With standard blank soft top jaw.

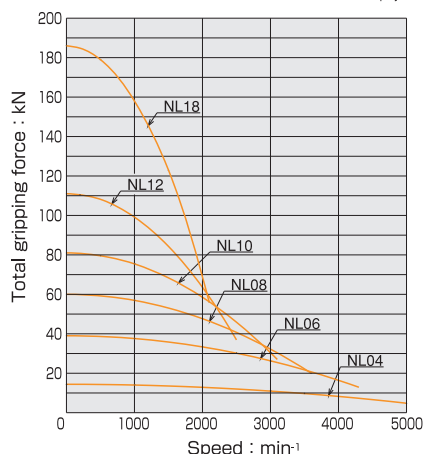

### Dimensions

| Dimensions Model | A   | B   | C (H6) | F | H     | K     | L  | M  | N max. | N min. | O max. | O min. | P max. | P min. | Q  | R    | S  | T   | U | V  | W  | X   | Y      | Z   |
|------------------|-----|-----|--------|---|-------|-------|----|----|--------|--------|--------|--------|--------|--------|----|------|----|-----|---|----|----|-----|--------|-----|
| NL04             | 110 | 52  | 60     | 6 | 80    | 3-M 8 | 12 | 14 | 26.5   | 20.45  | 9.75   | 6.75   | 18     | 3      | 23 | 10   | 25 | M10 | 3 | 26 | 27 | 55  | -      | -   |
| NL06             | 165 | 74  | 140    | 5 | 104.8 | 6-M10 | 14 | 20 | 40.5   | 34     | 13.75  | 9.25   | 101.5  | 81.5   | 31 | 12   | 36 | M16 | 4 | 34 | 35 | 72  | M6×10  | 116 |
| NL08             | 210 | 85  | 170    | 5 | 133.4 | 6-M12 | 20 | 25 | 48.1   | 40     | 20.75  | 11.75  | 131    | 106    | 35 | 14   | 36 | M20 | 5 | 38 | 42 | 95  | M6×12  | 150 |
| NL10             | 254 | 89  | 220    | 5 | 171.4 | 6-M16 | 18 | 30 | 54.4   | 45.35  | 29.5   | 11.5   | 161    | 133    | 40 | 16   | 36 | M20 | 5 | 45 | 46 | 110 | M8×15  | 190 |
| NL12             | 304 | 106 | 220    | 6 | 171.4 | 6-M16 | 18 | 30 | 65.7   | 56     | 42.75  | 12.75  | 47     | 17     | 50 | 18   | 46 | M24 | 5 | 50 | 54 | 129 | M8×15  | 190 |
| NL18             | 450 | 114 | 300    | 6 | 235   | 6-M20 | 30 | 43 | 110.5  | 97.5   | 47.25  | 23.25  | 97     | 57     | 50 | 25.5 | 55 | M30 | 2 | 55 | 61 | 135 | M10×20 | 260 |

### Specifications

| Specifications Model | Gripping range mm |      | Jaw Stroke (diameter) mm | Plunger Stroke mm | Max. Draw Bar Pull Force kN (kgf) | Max. Gripping Force kN (kgf) | Max. Speed min⁻¹ | Net Weight with Soft top jaws kg | Moment of inertia kg·m² | Matching Cylinder | Max. pressure MPa (kgf/cm²) | Matching Soft top jaw | Matching Hard top jaw |
|----------------------|-------------------|------|--------------------------|-------------------|-----------------------------------|------------------------------|------------------|----------------------------------|-------------------------|-------------------|-----------------------------|-----------------------|-----------------------|
|                      | Max.              | Min. |                          |                   |                                   |                              |                  |                                  |                         |                   |                             |                       |                       |
| NL04                 | 110               | 6    | 12.1                     | 15                | 10 (1020)                         | 14.4 ( 1468)                 | 5000             | 4.1                              | 0.008                   | Y0715R            | 2.9 (29.6)                  | SB04B1                | -                     |
| NL06                 | 165               | 22   | 13                       | 20                | 21 (2141)                         | 39 ( 3977)                   | 4300             | 12                               | 0.045                   | Y1020R            | 3.0 (30.6)                  | SB06B1                | HB06B1                |
| NL08                 | 210               | 23   | 16.2                     | 25                | 30 (3059)                         | 60 ( 6118)                   | 3600             | 22.9                             | 0.138                   | Y1225R            | 2.9 (29.6)                  | SB08B1                | HB08A1                |
| NL10                 | 254               | 27   | 18.1                     | 28                | 40 (4079)                         | 81 ( 8260)                   | 3100             | 34.6                             | 0.300                   | Y1530R            | 2.8 (28.6)                  | SB10A1                | HB10A1                |
| NL12                 | 304               | 32   | 19.4                     | 30                | 54 (5506)                         | 111 (11319)                  | 2500             | 60                               | 0.725                   | Y1530R            | 3.6 (36.7)                  | SB12A1                | HB12B1                |
| NL18                 | 450               | 124  | 26                       | 40                | 91 (9279)                         | 186 (18966)                  | 2100             | 124                              | 2.35                    | Y2050R            | 3.5 (35.9)                  | SB15N1                | -                     |