

Vacuum Pump



We now offer an Electric Vacuum Pump/Air Compressor option for use with all of our vacuum systems or your current system. This unit is compact, quiet and guaranteed to run continuously for 1 year!

The Pump produces a high evacuation rate of 5 cfm which is recommended for larger parts or difficult gasket sealing situations as the pump can compensate for gasket leakage much better. At dead head the vacuum pump develops approximately 12-13 psi of vacuum holding force. Mitee-Bite recommends using our Coolant Trap between fixture and pumps, so that any liquid that bypasses the gasket can be captured so not to affect vacuum performance.

The Pump is available operating on 115 volt or 230 volt and includes our coolant trap, air filter, non-skid feet & 10' power cord with on/off switch. The 230 volt cord will have flying leads* due to the wide variety of plugs.

*No plug on end of cord.

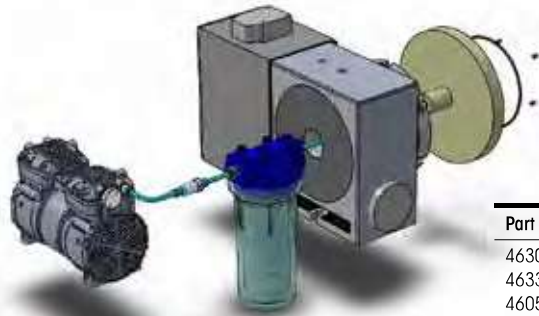

Part No.	Description
46300	Vacuum Pump/Air compressor wired 115 volt Coolant Trap, fittings, hoses & hardware included
46330	Vacuum Pump/Air compressor wired 230 volt Coolant Trap, fittings, hoses & hardware included
46050	Coolant Trap with hose and fittings

Chip Hooks



The chip hook is an essential safety tool for all shops. These galvanized steel hooks are fitted with a protective polyethylene hilt and wooden handles to ensure a firm grip. Available in several lengths and single or double handles.

SINGLE HANDLE HOOK WITH PROTECTING HILT

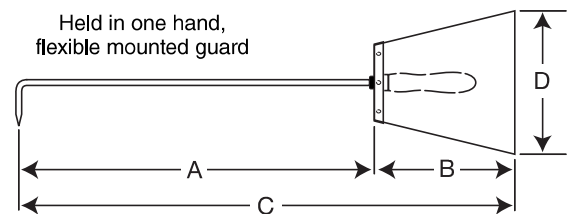

DOUBLE HANDLE HOOK WITH PROTECTING HILT

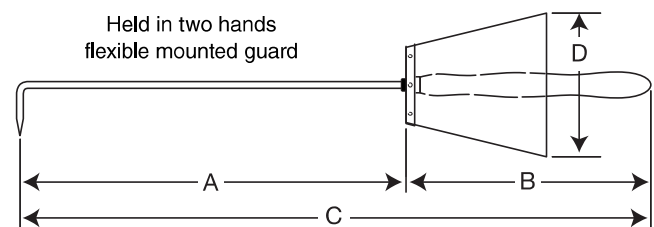

Part Number	Description	A (metric)	B (metric)	C (metric)	D (metric)
SINGLE HANDLE					
12060	Chip hook, single handle	15.75 (400)	7.0 (180)	22.5 (570)	7.0 (180)
12070	Chip hook, single handle	20.0 (500)	7.0 (180)	26.0 (670)	7.0 (180)
DOUBLE HANDLE					
12080	Chip hook, double handle	20.0 (500)	13.0 (320)	32.0 (820)	7.0 (180)
12090	Chip hook, double handle	31.5 (800)	13.0 (320)	44.0 (1120)	7.0 (180)
12100	Chip hook, double handle	39.0 (1000)	13.0 (320)	52.0 (1320)	7.0 (180)

SAFETY! A work related accident can happen very easily. Always use a chip hook to clear away annoying chips and empty the chip trays on your machines.