

SINGLE-WEDGE PULL-DOWN, SERRATED

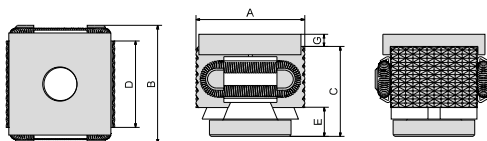

Bolt not included	Type	A			B	C m a x	D	E	G	Socket Head Screw DIN 912	Pressing force of Jaws, kN max	Tightening torque, Nm max	Weight in g approx.	Hardness of jaws HRC
		min	optimum	max										
	BK2-VT-PD	27	29	31	29	22	21	7	3	M8x20	25	44	68	48-52

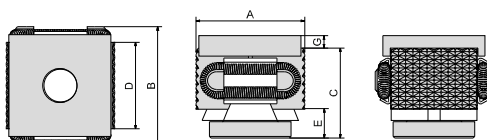

DK2-VTI-PD measures given in inches and ounces.

Bolt not included	Type	A			B	C m a x	D	E	G	Socket Head Screw DIN 912	Pressing force of Jaws, kN max	Tightening torque, Nm max	Weight in g (**oz) approx.	Hardness of jaws HRC
		min	optimum	max										
	DK2-VT-PD	42	45	49	41	32	30	10	4	M12x60	65	145	270	48-52
	DK2-VTI-PD	1.65	1.77	1.93	1.61	1.26	1.18	0.39	0.16	1/2	65	145	9.54*	48-52

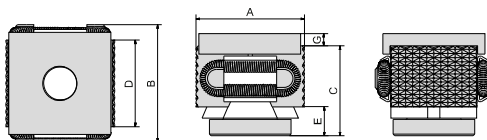

Bolt not included	Type	A			B	C m a x	D	E	G	Socket Head Screw DIN 912	Pressing force of Jaws, kN max	Tightening torque, Nm max	Weight in g approx.	Hardness of jaws HRC
		min	optimum	max										
	FK2-VT-PD	57	61	65	56	40,5	42	11,5	5	M16x60	110	360	620	48-52