

Side Clamp Workholder

Side Clamp A

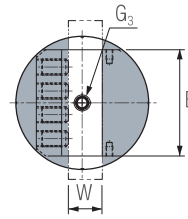
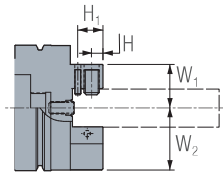
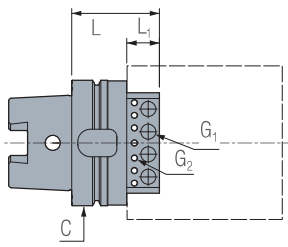

SAK63-10-55

Part No.	HSK Type	W	W ₁	W ₂	B	L	L ₁	∅C	H	H ₁	G ₁ (Bolt)	G ₂	G ₃	Kg
SAK-A40-10-40	HSK-A40	5~10	13	18.6	30	40	11	39	4.5	-	M6×L10	-	M6	0.5
SAK-A63-10-55	HSK-A63	5~10	20	23.5	50	55	21	62	7.5	17	M6×L15	M5	M10	1.1
SAK-A63-20-55		15~20	25	28.5	50	55	21	62	7.5	17	M6×L15	M5	M10	1.1
SAK-A100-20-70	HSK-A100	12~20	29.5	34	80	70	26	99	9	20	M12×L20	M5	M12	3.6
SAK-A100-30-70		22~30	34.5	39	80	70	26	99	9	20	M12×L20	M5	M12	3.6

Standard Accessories

- Large screw(G₁) ×2 pcs.

Side Clamp B

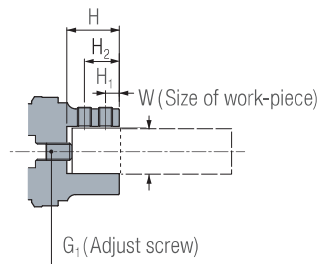
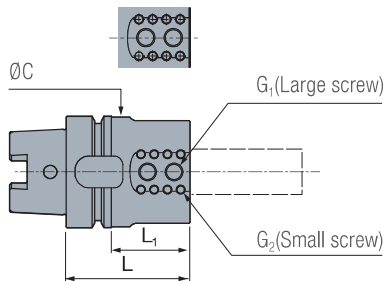

SBK63-30-70

Part No.	HSK Type	W	L	L ₁	∅C	H	H ₁	H ₂	G ₁	G ₂	G ₃	Kg
SBK-A40-20-55	HSK-A40	15~20	55	30	49	25	11	-	M8×16	M4×12	M10	0.5
SBK-A63-20-65	HSK-A63	15~20	65	30	49	25	11	-	M8×16	M4×12	M10	1.2
SBK-A63-25-70		20~25	70	35	56	30	8	20	M8×16	M4×12	M10	1.3
SBK-A63-30-70		20~30	70	44	62	35	9	24	M10×20	M5×12	M10	1.4
SBK-A63-40-85		35~40	85	52	76	45	12	30	M10×20	M6×12	M10	1.9
SBK-A100-20-70		HSK-A100	15~20	70	30	49	25	11	-	M8×16	M4×12	M10
SBK-A100-25-75	20~25		75	35	56	30	8	20	M8×16	M4×12	M10	3.4
SBK-A100-30-80	25~30		80	35	62	35	9	24	M10×20	M5×12	M10	3.5
SBK-A100-40-90	35~40		90	45	76	45	12	30	M10×20	M5×12	M10	3.9

Standard Accessories

- Large screw(G₁) ×4 pcs.