

RotaVice

by

1st MTA



The RotaVice has been designed to improve set up times for indexing operations on milling machines, offering additional advantages over the standard dividing head.



Quick Set Up

The RotaVice can be set up on an existing Chick OneLOK, mounted using specially designed jaws, allowing for **setup in under a minute** with less than 20µ repeatability.



Precision Indexing

When machining **one-off parts at irregular angles**, the RotaVice is equipped with a **toggle device** which can adjust the required angle down to 0.5°.

Zero Disruption

Once operations have been completed, the RotaVice can be removed without disrupting the original Chick One-Lok. Leaving everything in place means there is **no need to clock in your setups**.

RotaVice

by

1st MTA

Heavier Machining

Standard dividing heads don't clamp when in position. This means machining forces need to be kept fairly low. The RotaVice has a **clamping system which allows for larger cuts** on your part, and a more rigid setup. All of this leads to **faster machining times and a better surface finish**.

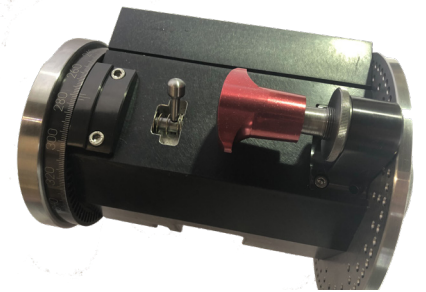

Simplified Indexing

The RotaVice's standard dividing plate allows for parts to be indexed in standard increments of **5°**, **15°** and **45°**. Alternatively, there is the option to replace it with a **custom plate to suit your operations**, offering even speedier set up times.



Improved Z Height

The RotaVice axis is lower to the machine bed, allowing for a larger Z axis movement for your tooling.

RotaVice by 1st MTA

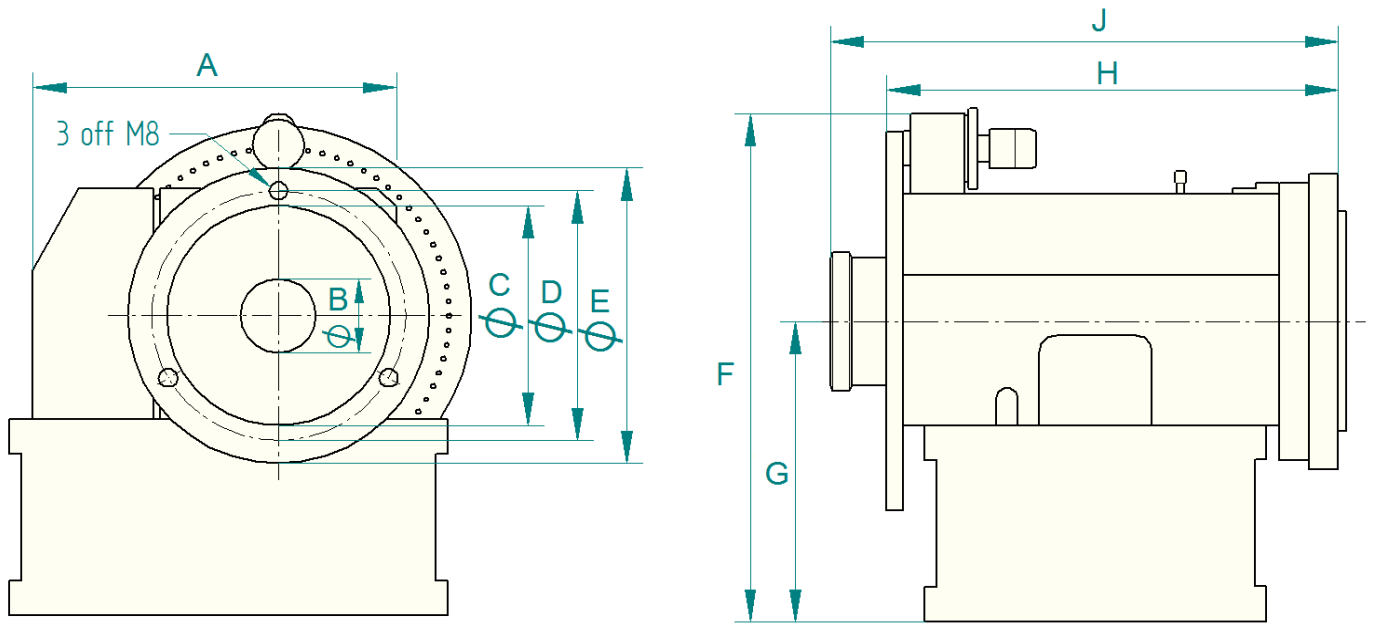

A	B	C	D	E	F	G	H	I
147	32	95	108	128	145	130	194	215.5

Optional Extras

*5 Inch
Scroll Chuck*

*Work
Stop*

*Fixture
Plate*

*Expanding
Mandrels*

