

PRODUCT INFO

⑤ 5QL1550-AL / 5QL1550-CI

1550 Qwik-Lok Product Information

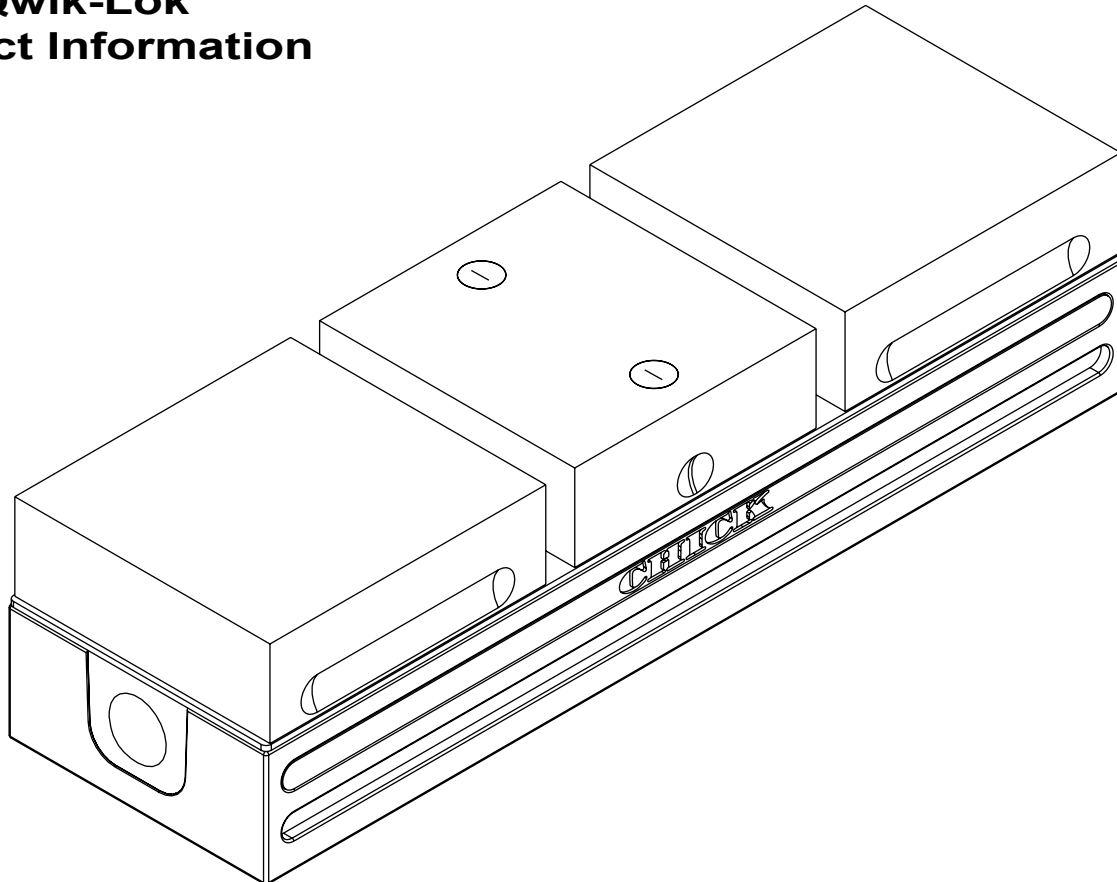

SPARE PARTS

5 5QL1550-AL / 5QL1550-CI SYSTEM 5

NOTES

For QwikChange Jaw accessories, see pages 2-3

- * Included in a standard 1550 Qwik-Lok

Faceplate Round & Diamond Pins

(Included w/ Faceplate purchase)

5PIN14S

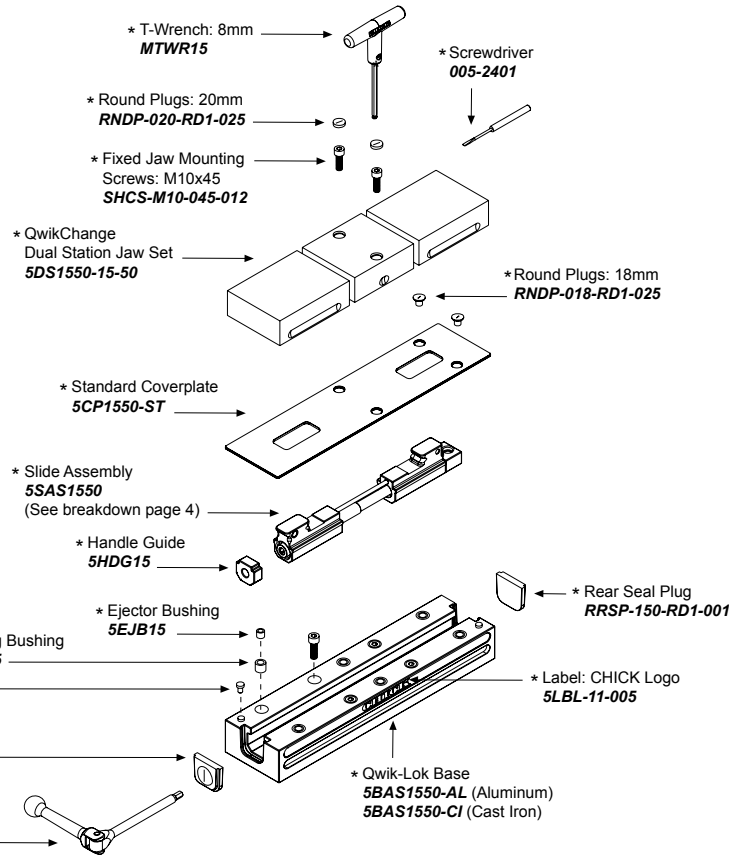
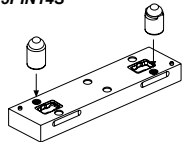

MOUNTING

Foundation

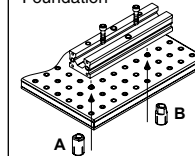

- A Round Pin..... **MPIN12R**
- B Diamond Pin... **MPIN12D**
- A & B Set..... **MPIN12S**

T-Slotted Table

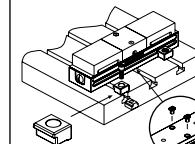

Toe Clamps

005-0254

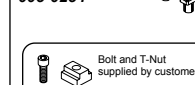

Bolt and T-Nut supplied by customer

Locating Keys

Inch Size

- MKE500** (1/2")
- MKE562** (9/16")
- MKE625** (5/8")
- MKE688** (11/16")
- MKE750** (3/4")
- MKE812** (13/16")

Metric Size

- MKE10** (10mm)
- MKE12** (12mm)
- MKE14X18** (14mm)
- MKE16** (16mm)
- MKE20** (20mm)

Bottom of Base

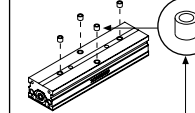

- * Locating Bushing: 12mmx18mmx12mm **025-0370**

ACCESSORY SETS

5 5QL1550-AL / 5QL1550-CI SYSTEM 5

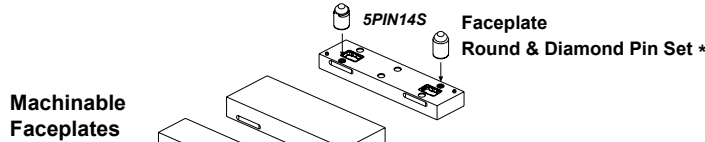

Machinable Faceplates

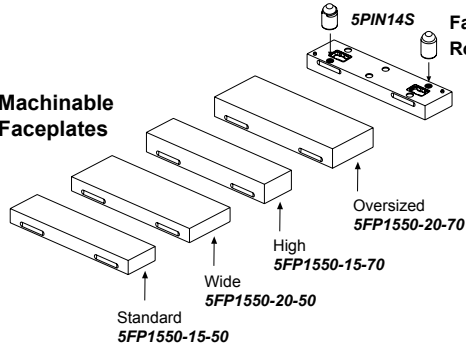

Dual Station Machinable Jaw Sets

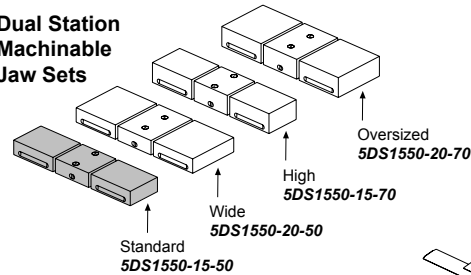

Single Station Machinable Jaw Sets

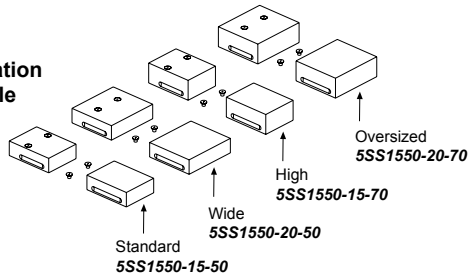

Coverplates

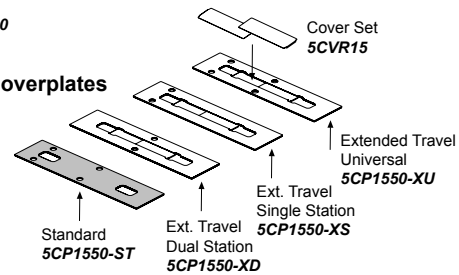

Jaw Carrier Sets

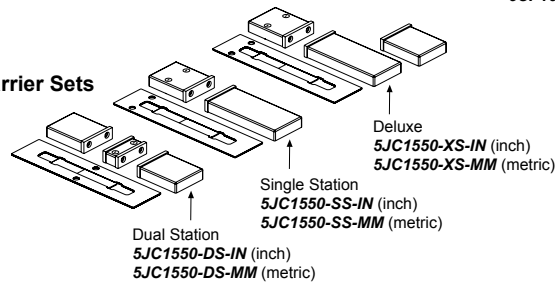

Conversion Faceplates

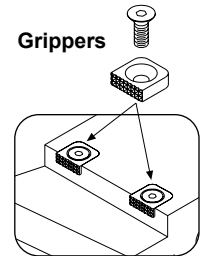
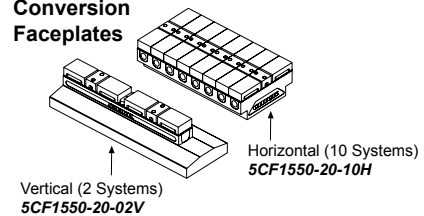

Grippers

Gripper #3
Plain 005-2531
Serrated 005-2532
(L-9mm x W-9mm x T-3mm)

Gripper #4
Plain 005-2541
Serrated 005-2542
(L-12mm x W-12mm x T-4.6mm)

Gripper #5
Plain 005-2551
Serrated 005-2552
(L-15mm x W-15mm x T-5mm)

Gripper #6
Plain 005-2561
Serrated 005-2562
(L-19mm x W-19mm x T-6mm)

NOTES

■ Included with a standard system

* Required for both Machinable and Conversion Faceplates.
(Included with Faceplate purchase)

INDIVIDUAL ACC.

5 5QL1550-AL / 5QL1550-CI SYSTEM 5

* or  Included with a standard system

QwikChange Machinable Dual Station Jaws

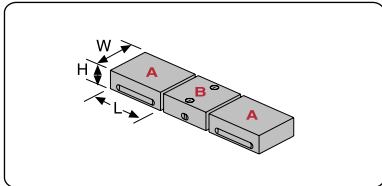

Individual Dual Station Jaws

Standard

- A** Moveable Jaw **5MJ1550-15-50**
(W148mm, H50mm, L160mm)
- B** Fixed Jaw **5FJ1550-15-50**
(W148mm, H50mm, L120mm)

Wide

- A** Moveable Jaw **5MJ1550-20-50**
(W198mm, H50mm, L160mm)
- B** Fixed Jaw **5FJ1550-20-50**
(W198mm, H50mm, L120mm)

High

- A** Moveable Jaw **5MJ1550-15-70**
(W148mm, H70mm, L160mm)
- B** Fixed Jaw **5FJ1550-15-70**
(W148mm, H70mm, L120mm)

Oversized

- A** Moveable Jaw **5MJ1550-20-70**
(W198mm, H70mm, L160mm)
- B** Fixed Jaw **5FJ1550-20-70**
(W198mm, H70mm, L120mm)

QwikChange Machinable Single Station Jaws

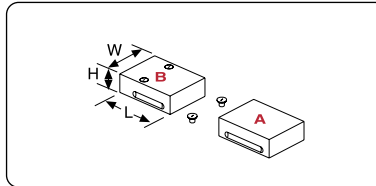

Individual Single Station Jaws

Standard

- A** Moveable Jaw **5MJ1550-15-50**
(W148mm, H50mm, L160mm)
- B** Fixed Jaw **5SJ1550-15-50**
(W148mm, H50mm, L160mm)

Wide

- A** Moveable Jaw **5MJ1550-20-50**
(W198mm, H50mm, L160mm)
- B** Fixed Jaw **5SJ1550-20-50**
(W198mm, H50mm, L160mm)

High

- A** Moveable Jaw **5MJ1550-15-70**
(W148mm, H70mm, L160mm)
- B** Fixed Jaw **5SJ1550-15-70**
(W148mm, H70mm, L160mm)

Oversized

- A** Moveable Jaw **5MJ1550-20-70**
(W198mm, H70mm, L160mm)
- B** Fixed Jaw **5SJ1550-20-70**
(W198mm, H70mm, L160mm)

QwikChange Jaw Carriers

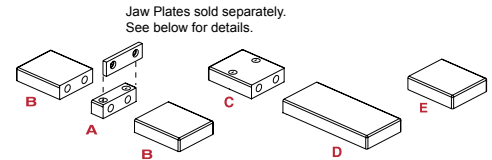

Jaw Carriers (Inch)

- A** **5JC1550-FC-IN**
- B** **5JC1550-MC-IN**
- C** **5JC1550-SC-IN**
- D** **5JC1550-LM-IN**
- E** **5JC1550-SM-IN**

Jaw Carriers (Metric)

- A** **5JC1550-FC-MM**
- B** **5JC1550-MC-MM**
- C** **5JC1550-SC-MM**
- D** **5JC1550-LM-MM**
- E** **5JC1550-SM-MM**

- A** Dual Station Fixed
- B** Dual Station Moveable
- C** Single Station Fixed
- D** Single Station Long Moveable
- E** Single Station Short Moveable

Jaw Plates

Standard

- (Set of 4)
- JH6STD** (Inch)
- MJH15** (Metric)

Thick

- (Set of 2)
- JH6THK**

Both Sizes

- JH6STD** &
- JH6THK**

HARD JAW PLATES

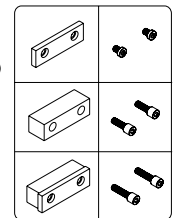

- Standard Mounting Screws: 1/2-13x5/8"
- LHCS-500-063-008** (Inch)
- LHCS-M10-012-008** (Metric)

- Thick Mounting Screws: 1/2-13x1.25"
- SHCS-500-125-008**

- Both Sizes Mounting Screws: 1/2-13x1.75"
- SHCS-500-175-008**

SOFT JAW PLATES

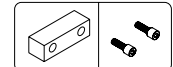

- Standard (Set of 4)
- JS6AL**

- Soft Mounting Screws: 1/2-13x1.25"
- SHCS-500-125-012**

Faceplate Round & Diamond Pin Set

(Included w/ Faceplate purchase)

Required for both Machinable and Conversion Faceplates.

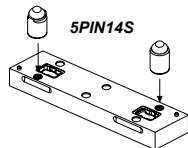

Screws and Plugs

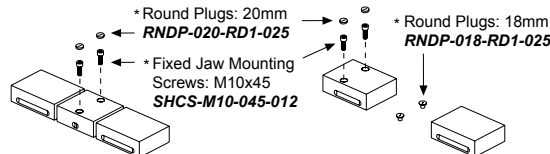

SLIDE ASSEMBLY

5 5QL1550-AL / 5QL1550-CI SYSTEM 5

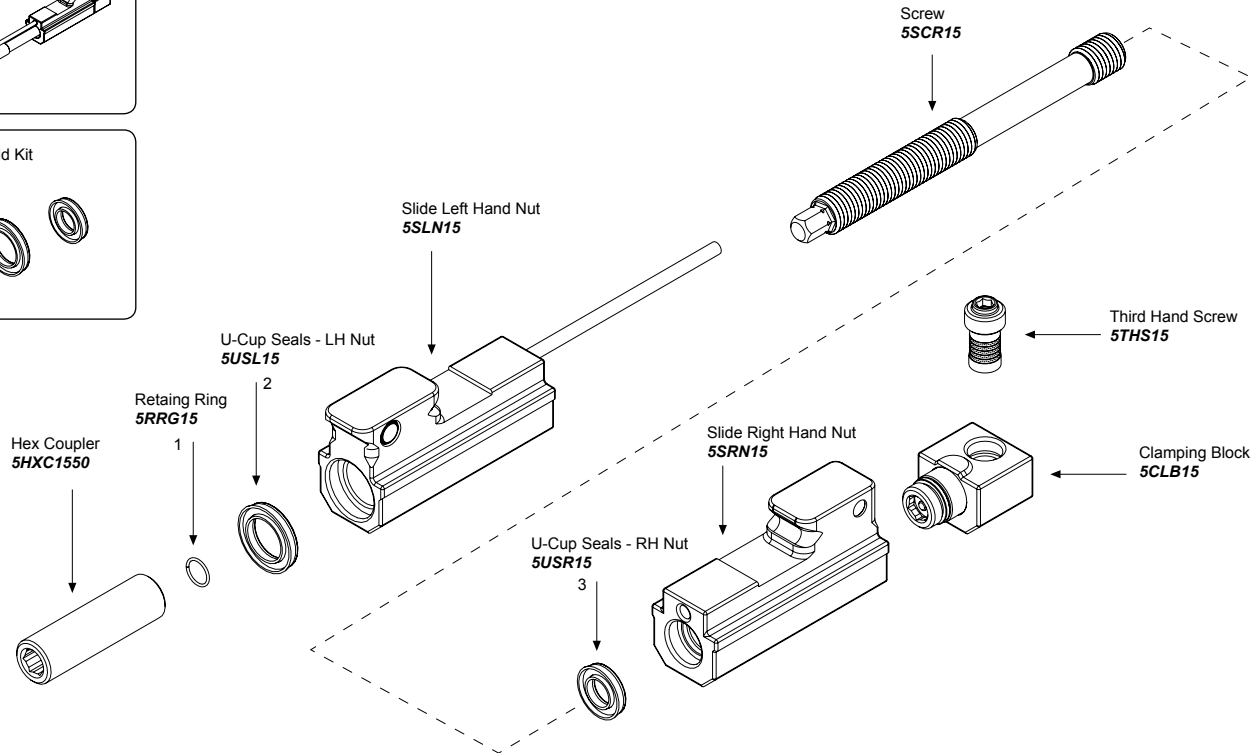
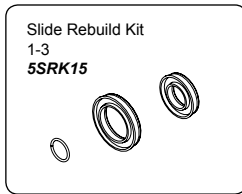
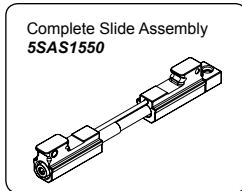

DIMENSIONS

5 5QL1550-AL / 5QL1550-CI SYSTEM 5

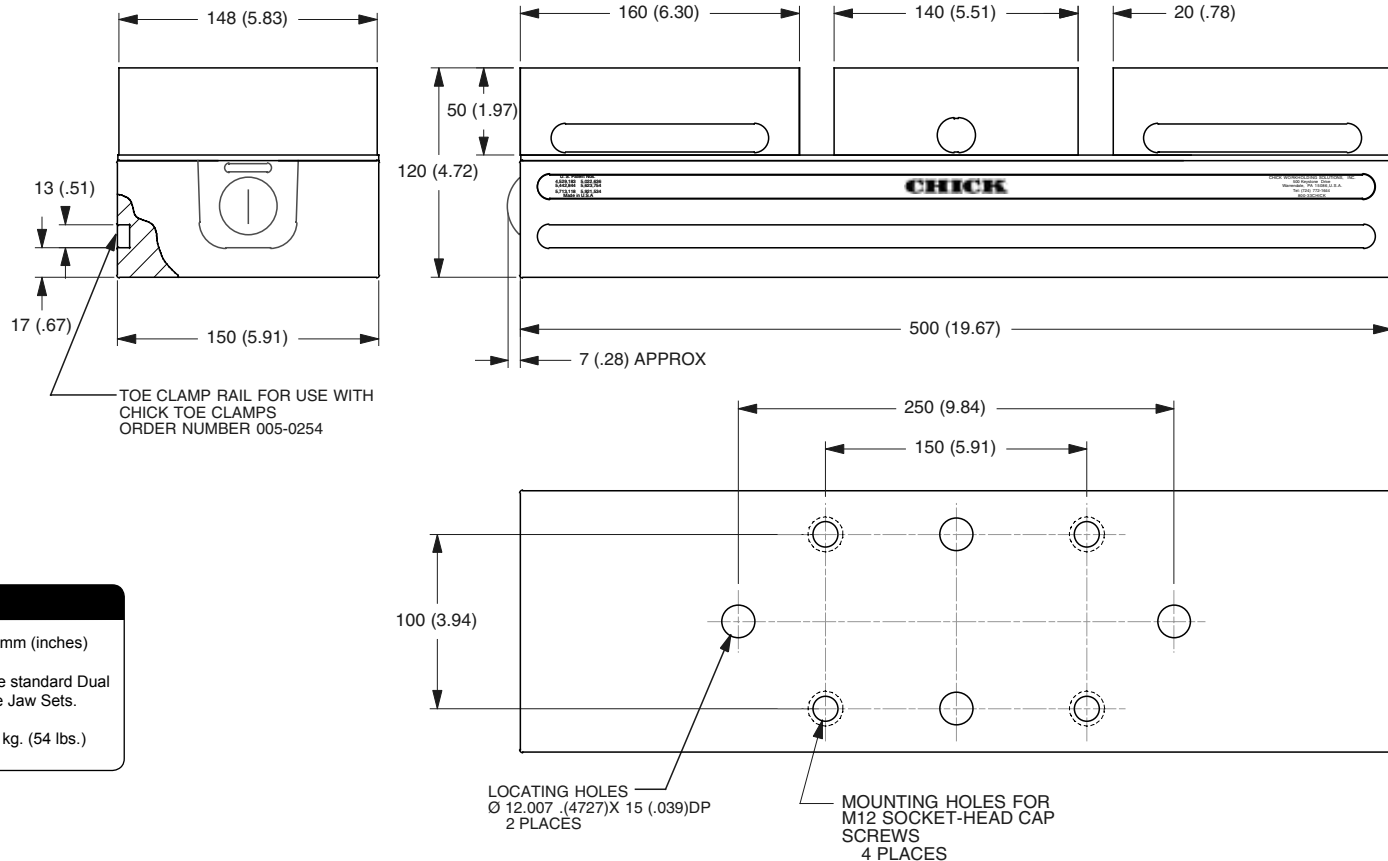

NOTES

- Dimensions are in mm (inches)
- Dimensions include standard Dual Station Machinable Jaw Sets.
- System weight: 24 kg. (54 lbs.)

5 5QL1550-AL / 5QL1550-CI

SYSTEM 5

Dual Station

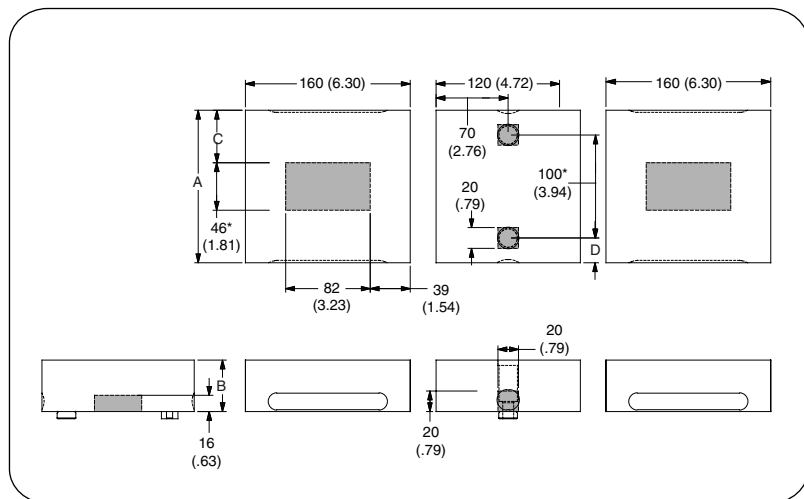

Item Number	Description	A	B	C	D
5DS1550-15-50	Standard	148 (5.83)	50 (1.97)	51 (2.01)	24 (.94)
5DS1550-15-70	High	148 (5.83)	70 (2.76)	51 (2.01)	24 (.94)
5DS1550-20-50	Wide	198 (7.80)	50 (1.97)	76 (2.99)	49 (1.93)
5DS1550-20-70	Oversized	198 (7.80)	70 (2.76)	76 (2.99)	49 (1.93)

Single Station

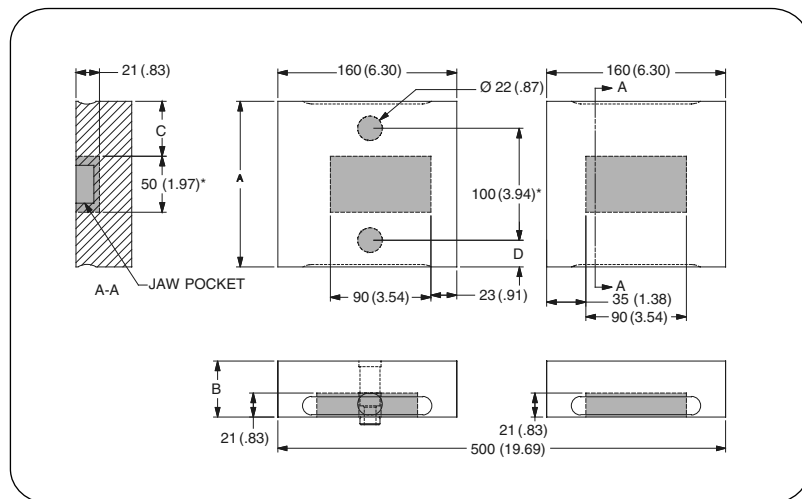

Item Number	Description	A	B	C	D
5SS1550-15-50	Standard	148 (5.83)	50 (1.97)	49 (1.93)	24 (.94)
5SS1550-15-70	High	148 (5.83)	70 (2.76)	49 (1.93)	24 (.94)
5SS1550-20-50	Wide	198 (7.80)	50 (1.97)	74 (2.91)	49 (1.93)
5SS1550-20-70	Oversized	198 (7.80)	70 (2.76)	74 (2.91)	49 (1.93)

NOTES

■ No cut zone

Dimensions are in mm (inches)

* Dimensions centered on the "A" dimension.

JAW TRAVEL

5 5QL1550-AL / 5QL1550-CI SYSTEM 5

Dual Station

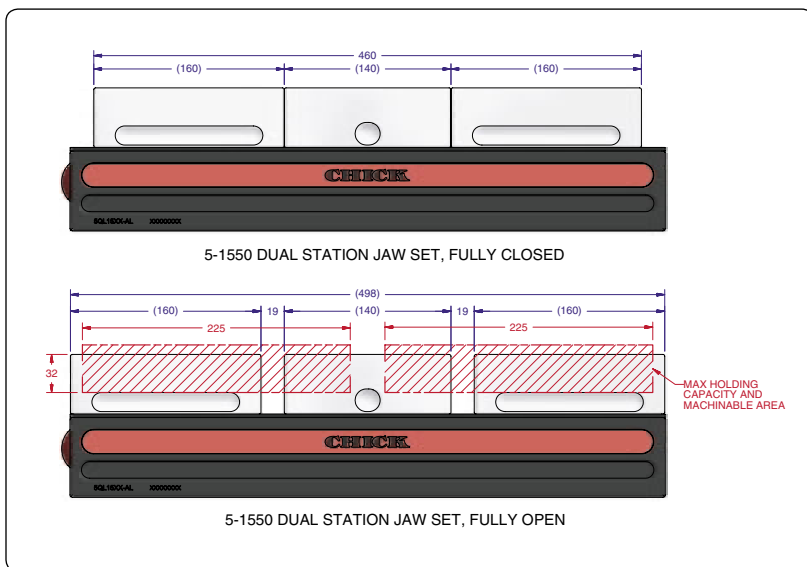

Single Station

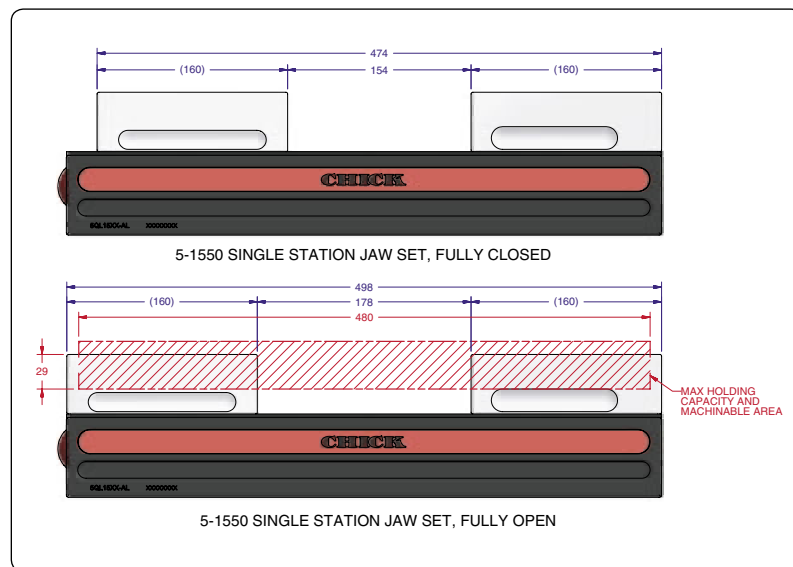

Item Number	Description	A	Jaw Width
5DS1550-15-50	Standard	32 (1.26)	148 (5.83)
5DS1550-15-70	High	52 (2.05)	148 (5.83)
5DS1550-20-50	Wide	32 (1.26)	198 (7.80)
5DS1550-20-70	Oversized	52 (2.05)	198 (7.80)

Item Number	Description	A	Jaw Width
5SS1550-15-50	Standard	32 (1.26)	148 (5.83)
5SS1550-15-70	High	52 (2.05)	148 (5.83)
5SS1550-20-50	Wide	32 (1.26)	198 (7.80)
5SS1550-20-70	Oversized	52 (2.05)	198 (7.80)

NOTES

Dimensions are in mm (inches)

* Additional closure is available with an Extended Travel Cover-plate.

Contact CHICK for details.

CLAMPING FORCE

5 5QL1550-AL / 5QL1550-CI SYSTEM 5

Pounds (lbs)

Force	=	Torque	X	Slope
lbs	=	in-lb	x	6.4
lbs	=	ft-lbs	x	76.3

Torque (ft-lb)	Force (lbs)
0	0
10	763
20	1525
30	2288
40	3051
50	3814
60	4576
70	5339
80	6102
90	6864
95	7246
100	7627
105	8008
110	8390
115	8771
118	9000

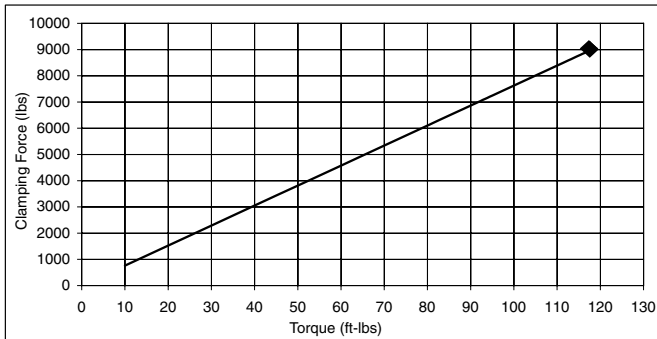

Note: ♦ Maximum Recommended Torque. Actual results may vary.

Kilo Newtons (kN)

Force	=	Torque	X	Slope
N	=	N-m	x	250
kN	=	N-m	x	0.25

Torque (N-m)	Force (kN)
0	0.0
10	2.5
20	5.0
30	7.5
40	10.0
50	12.5
60	15.0
70	17.5
80	20.0
90	22.5
100	25.0
110	27.5
120	30.0
130	32.5
140	35.0
150	37.5
160	40.0

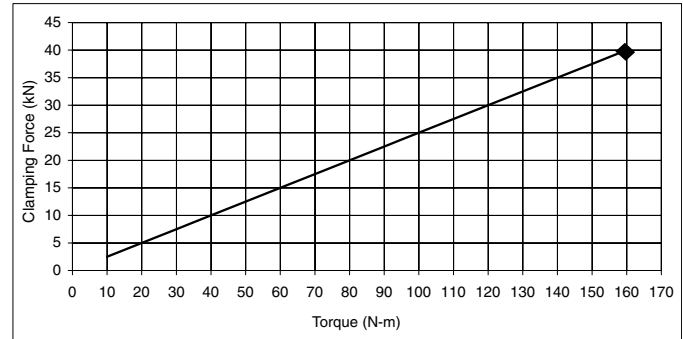

Note: ♦ Maximum Recommended Torque. Actual results may vary.