

Alustar

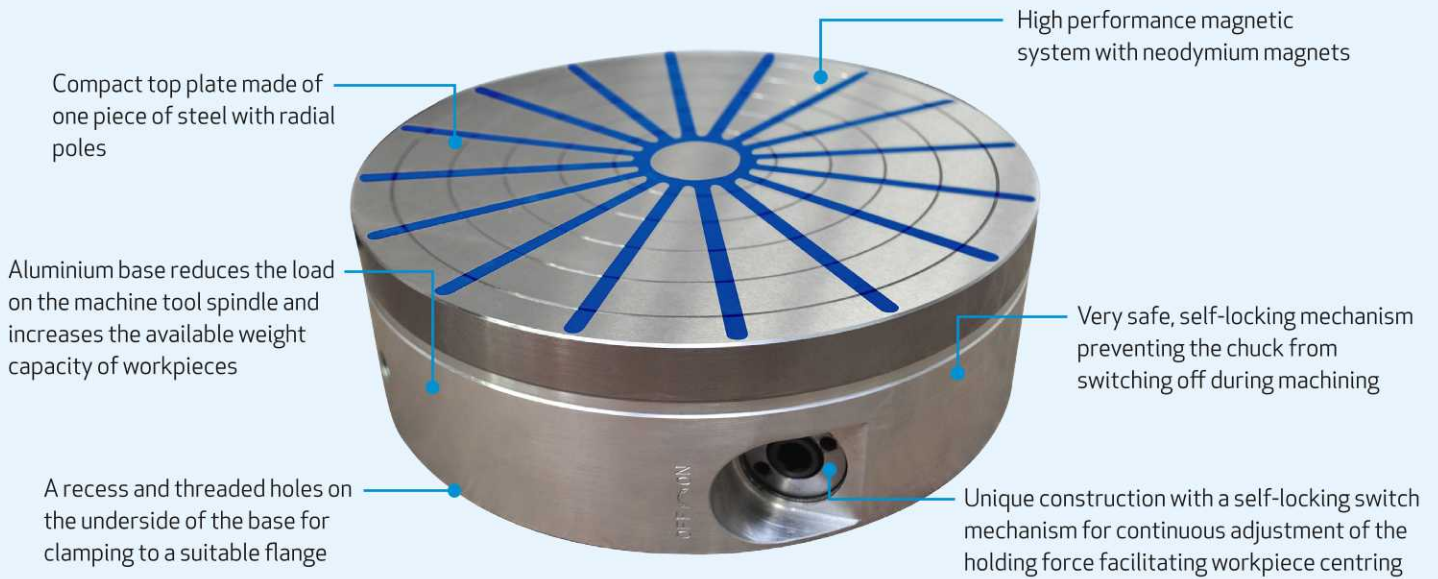

When to choose an Alustar permanent magnetic chuck:

The Alustar permanent chuck is used during turning and grinding of ring-shaped workpieces. The chuck excels due to its low weight resulting from the aluminium design of the body. It can cope with a larger weight range of machined components. With this chuck, you have the possibility to machine the front, inner and outer diameter of the workpiece in one operation.



APPLICATION	TECHNOLOGY	DIAMETER	HOLDING FORCE	POLES
 Turning	 Permanent	 from 200 mm	 140 N/cm ²	 Radial

Important parameters:

Application:	Turning, circular grinding
Technology:	Permanent
Holding force:	140 N/cm ²
Min. workpiece size:	40 mm
Poles:	Radial
Regrinding limit:	5 mm

Use:

+ turning and grinding of round and ring-shaped workpieces

Model	D (mm)	H (mm)	D1 (mm)	E (mm)	F (mm)	Weight (kg)	Number of poles
ALUS20D200 	200	79	20	110	180	11,5	12
ALUS20D250 	250	79	30	166	220	18	16
ALUS20D300 	300	82	38	180	260	27	16
ALUS20D350	350	82	40	220	300	36	20
ALUS20D400	400	84	40	260	340	47	20
ALUS30D500	500	109	50	330	400	98	24
ALUS30D600	600	109	90	350	450	142	30

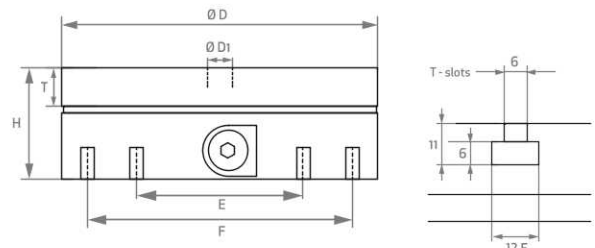

Alustar in use

